

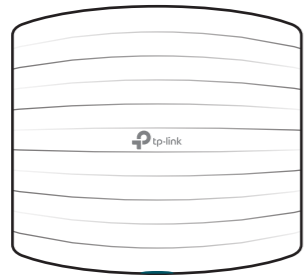

Quick Installation Guide

Wireless N Access Point
EAP115

LED Indication



- **Solid Green**
The device is working properly.
- **Flashing Yellow**
Firmware update is in progress. Do not disconnect or power off the device.
- **Flashing Red**
System errors. RAM, Flash, Ethernet, WLAN or firmware may be malfunctioning.
- **Double-flashing Red, Green, Yellow**
The device is being reset to its factory default settings.

Interface Panel

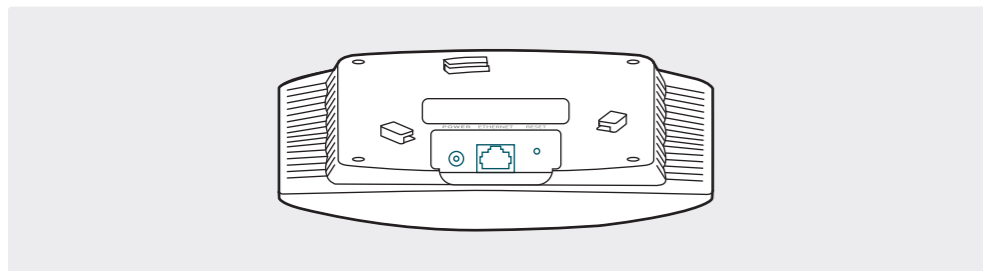

RESET

With the device powered on, press and hold the button for about 5 seconds until the LED flashes red, then release the button. The device will restore to factory default settings.

ETHERNET

The port is used to connect to a router or a switch to transmit data or to a PSE (Power Sourcing Equipment), such as a PoE switch, for both data transmission and Power over Ethernet (PoE) through Ethernet cable.

POWER

The port is used to connect to the provided power adapter to power the EAP. The other end of the power adapter connects to a standard electrical wall outlet.

1 Typical Network Topology

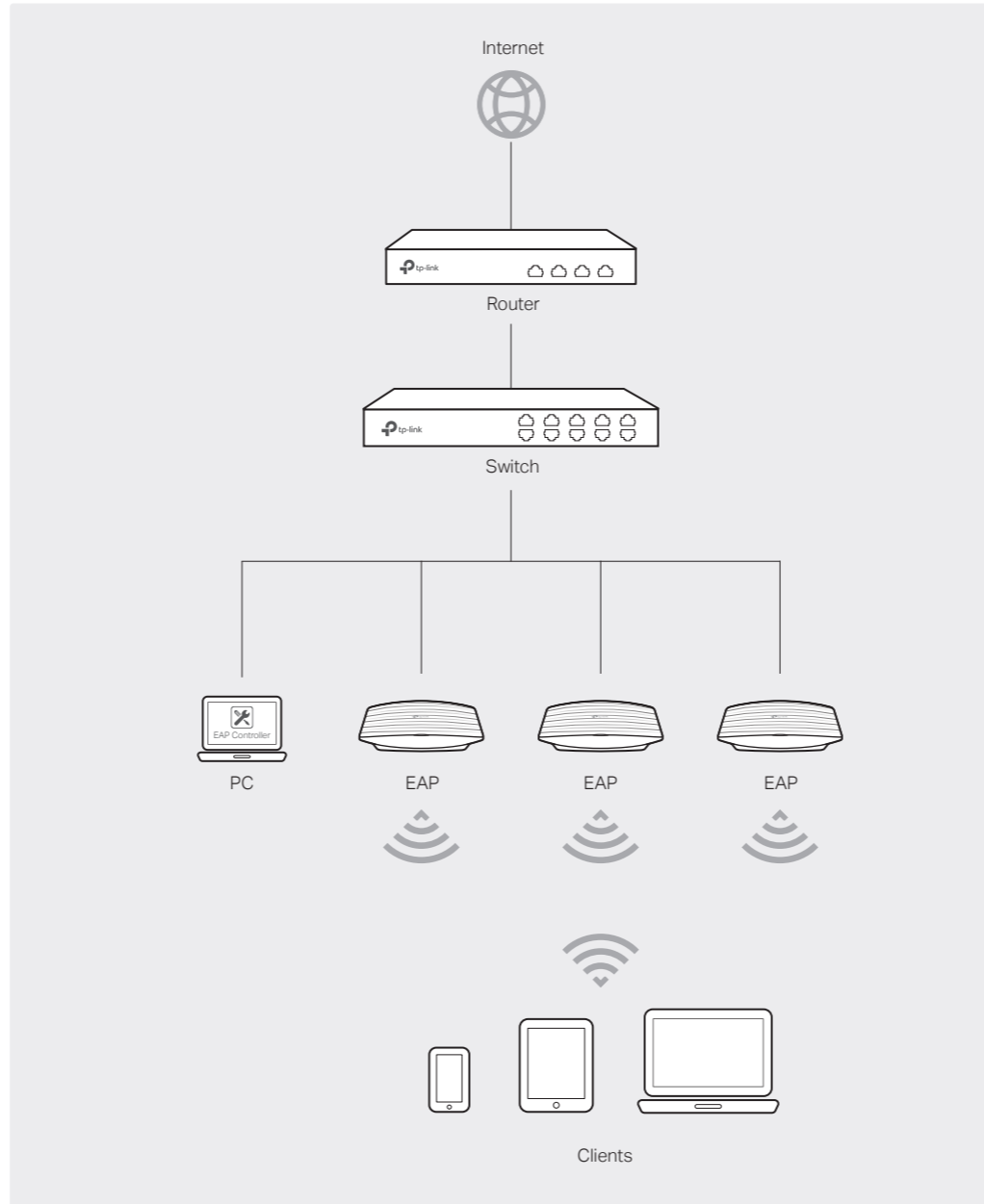

• A DHCP server (typically a router) with DHCP function enabled is required to assign IP addresses to the EAPs and clients in your local network.

2 Hardware Installation

The EAP can be ceiling-mounted or wall-mounted.

Option 1: Ceiling Mounting

Option 2: Wall Mounting

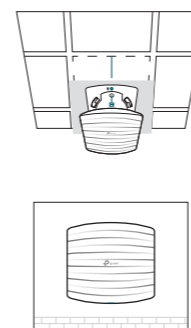

Option 1: Ceiling Mounting

Note: Make sure that the ceiling tile is bigger than the EAP (190*172mm).

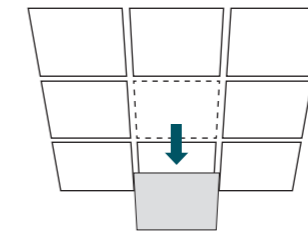
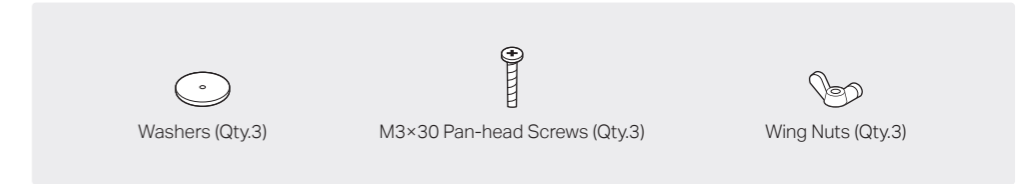

1 Remove the ceiling tile.

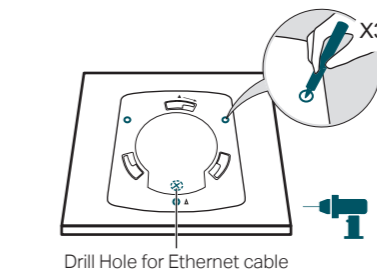

2 Place the mounting bracket in the center of the ceiling tile. Mark three positions for the screw holes and a position for the Ethernet cable hole. Drill three 4mm diameter holes for the screws and a 25mm diameter hole for the Ethernet cable at the marked positions.

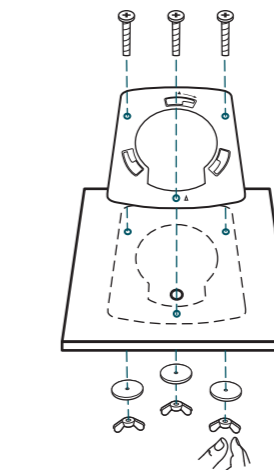

3 Secure the mounting bracket to the ceiling tile using three M3x30 pan-head screws, washers and wing nuts, as shown on the left.

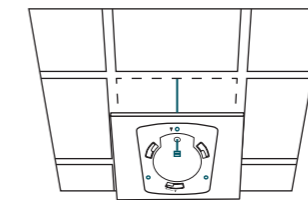

4 Feed the Ethernet cable through the hole and set the ceiling tile back into place.

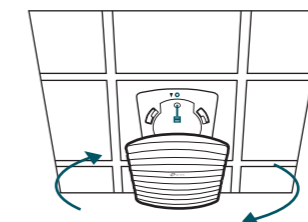

5 Connect the Ethernet cable to the ETHERNET port. Attach the EAP to the mounting bracket by aligning the arrow mark ▲ on the EAP with the arrow mark ▲ on the mounting bracket, then rotate the EAP until it is locked into place, as shown on the left.

Option 2: Wall Mounting

Note: For security reasons, it is recommended not to install the EAP with the louver downward.

M3×28 Plastic Wall Anchors (Qty.3)

M3×20 Self-tapping Screws (Qty.3)

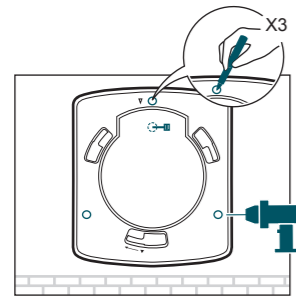

1
If your Ethernet cable feeds through the wall, you can position the mounting bracket to make the cable through the fixing hole. Mark three positions for the screw holes and then drill three 6mm diameter holes at the marked positions.

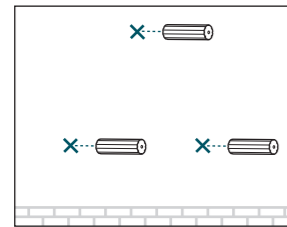

2
Insert the plastic wall anchors into the 6mm diameter holes.

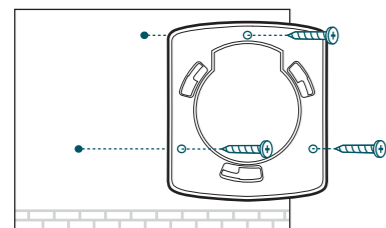

3
Secure the mounting bracket to the wall by driving the self-tapping screws into the anchors. Make sure that the shoulders of the mounting bracket are on the outside.

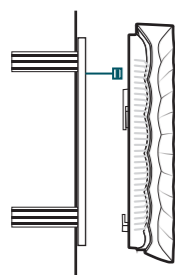

4
Connect the Ethernet cable to the ETHERNET port on the EAP.

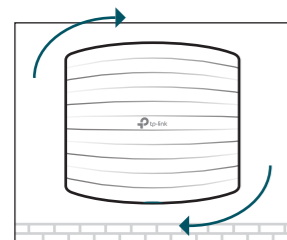

5
Attach the EAP to the mounting bracket by aligning the arrow mark ▲ on the EAP with the arrow mark ▲ on the mounting bracket, then rotate the EAP until it is locked into place, as shown on the left.

3 Power Supply

The EAP can be powered via a PSE device (such as a PoE switch) or a power adapter.

Via PoE Switch

Connect an Ethernet cable from the PoE switch to the ETHERNET port.

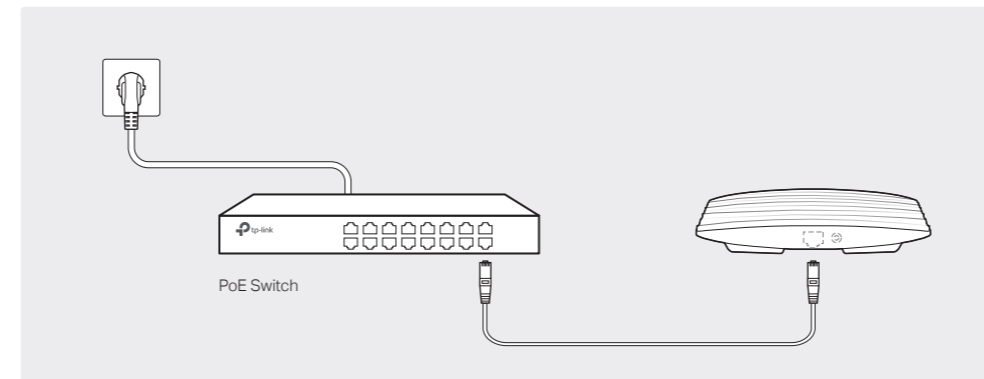

Via Power Adapter

Plug one end of the provided power adapter into the POWER port of the EAP and the other end to a standard electrical wall outlet.

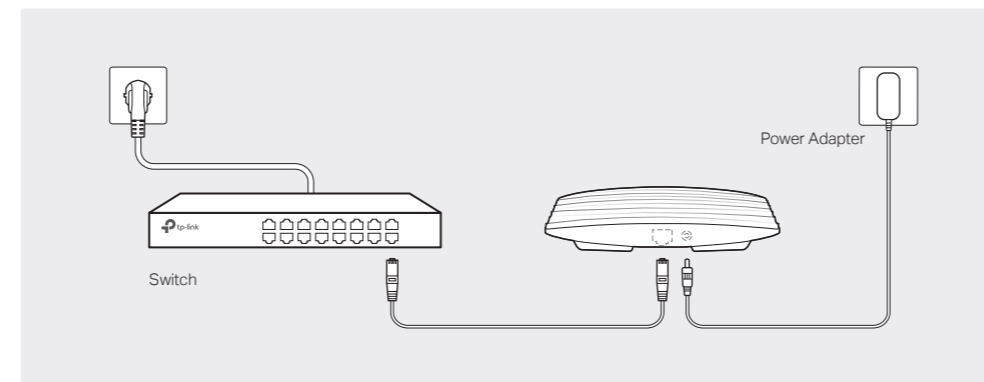

4 Software Configurations

The EAP supports two configuring options:

- To configure and manage mass EAPs via centralized controller software, please refer to **Option 1**.
- To configure a single EAP via a web browser directly, please refer to **Option 2**.

Option 1: Via EAP Controller

Step 1: Installing EAP Controller

On the PC, download the EAP Controller installation file from <http://www.tp-link.com/en/download/EAP-Controller.html>. Run the file and follow the wizard to install the EAP Controller.

Step 2: Configuring EAP Controller

Launch the EAP Controller and follow the step-by-step instructions to complete the Quick Setup. After the wizard is finished, a login screen will appear.

Step 3: Logging in to EAP Controller

Enter the admin name and password you created and click **Sign In**. Then you can further configure the EAP Controller.

For More Configurations

You can now manage your wireless network and view network statistics using the EAP Controller. Please refer to the EAP Controller User Guide for more information about configuring and using EAP Controller.

Option 2: Via Web Browser

Step 1: Connecting to the EAP Device

Power on the EAP and connect wirelessly by using the default SSID (format: TP-LINK_2.4GHz/5GHz_XXXXXX) printed on the product label.

Step 2: Logging in to the EAP Device

Launch a web browser and enter <http://tplinkeap.net> in the address bar. Use **admin** for both Username and Password to log in.

Step 3: Configuring the EAP Device

Set up a new Username and Password for secure management purpose. Modify the wireless parameters and reconnect your wireless devices to the new wireless network.



For technical support and other information, please visit <http://www.tp-link.com/support>, or simply scan the QR code.



The products of TP-Link partly contain software code developed by third parties, including software code subject to the GNU General Public License ("GPL"). As applicable, the terms of the GPL and any information on obtaining access to the respective GPL Code used in TP-Link products are available to you in GPL-Code-Centre under (<http://www.tp-link.com/en/support/gpl/>). The respective programs are distributed WITHOUT ANY WARRANTY and are subject to the copyrights of one or more authors. For details, see the GPL Code and other terms of the GPL.