



AC 3150 Wireless MU-MIMO Gigabit Router

The Next Wave 11ac
4-Stream Router



Archer C3150

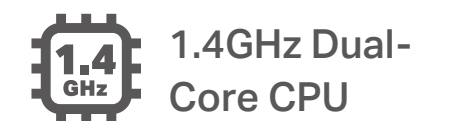
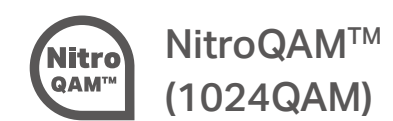
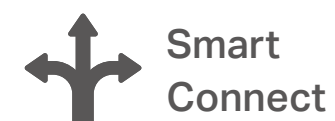
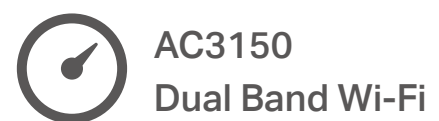

Highlights

NitroQAM™* and 4-Stream for Maximum Wi-Fi Speed

Break the Wi-Fi speed limit of previous generation routers with NitroQAM™ and 4-stream technology powered by Broadcom, achieving speeds of 1000Mbps on the 2.4GHz band and 2167Mbps on the 5GHz band.

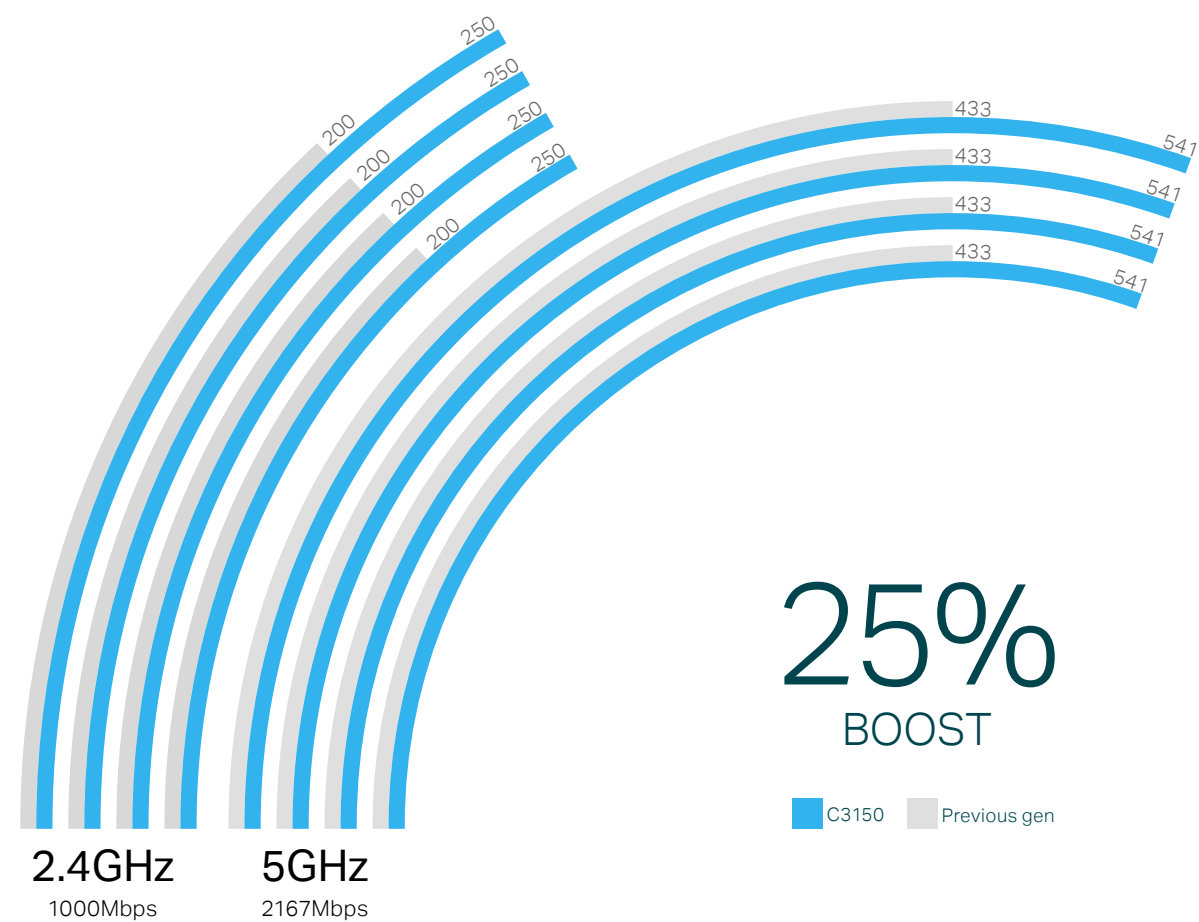

MU-MIMO for 4× Faster Connections

MU-MIMO technology serves up to four devices at once, reducing wait time, increasing Wi-Fi throughput for every device, and making each stream more efficient.

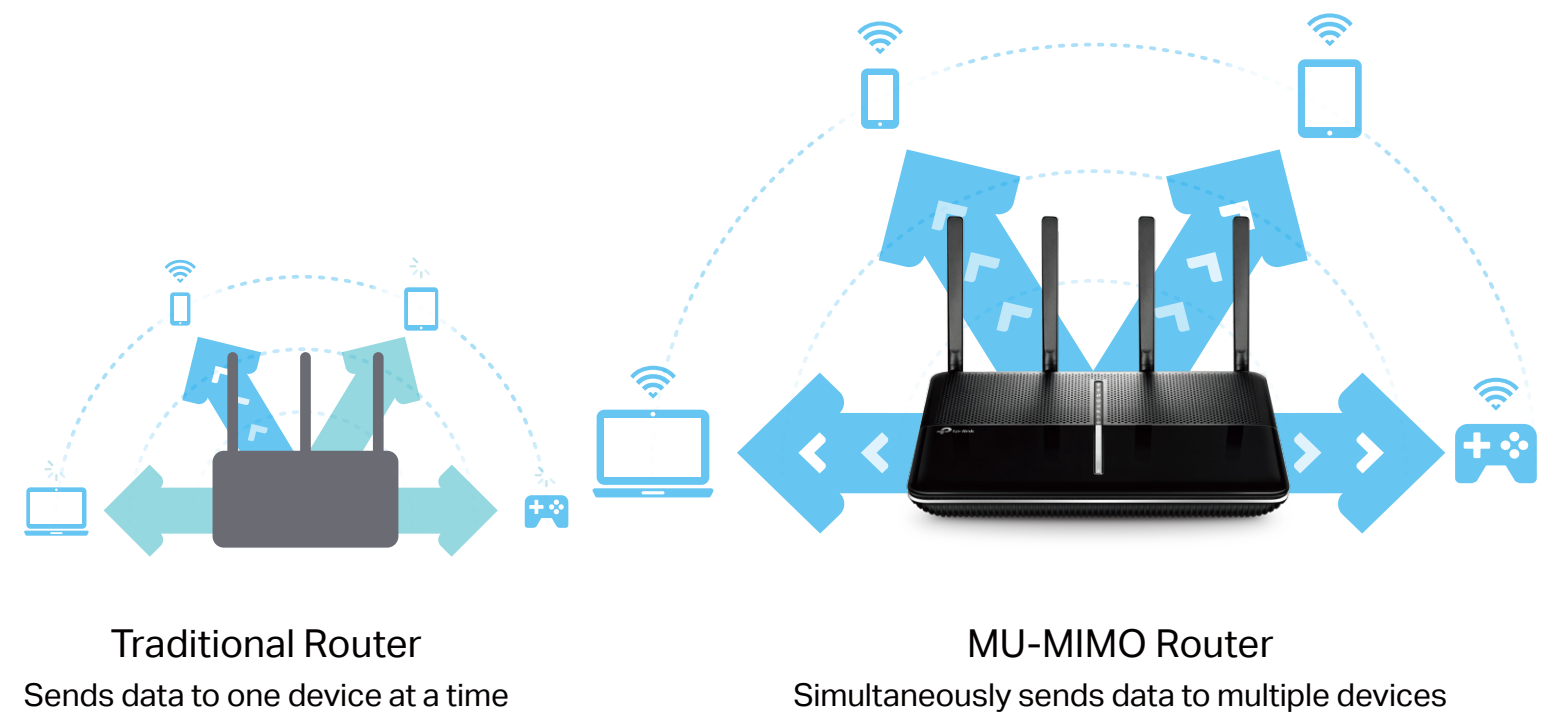

Highlights

Smart Connect for Better Connections

Smart Connect technology surveys the Wi-Fi environment to intelligently assign devices to the best available band, balancing the network load to give each device optimized connection and throughput.

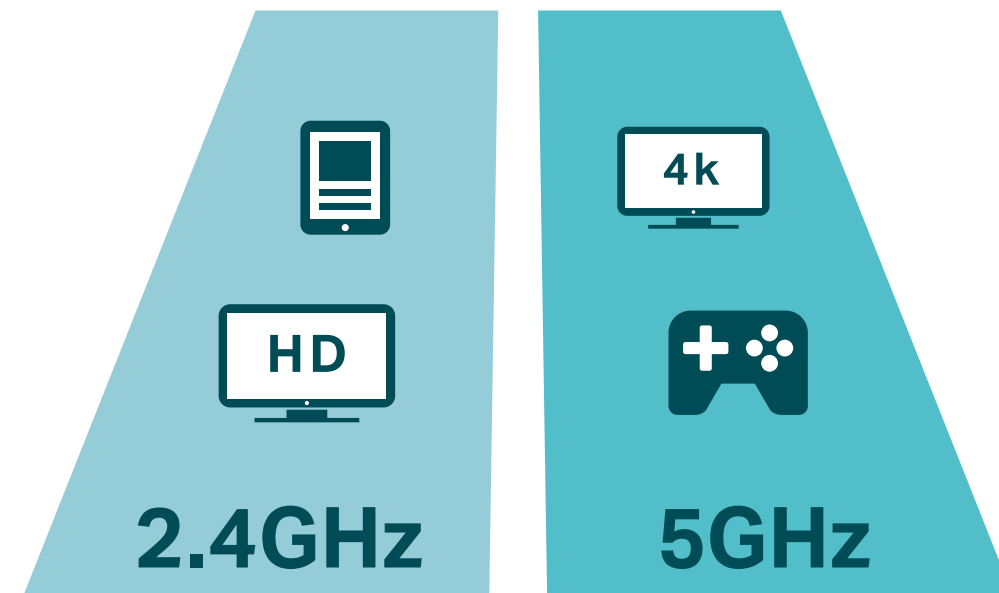

1.4GHz Dual-Core CPU + 2 Co-Processors

The Archer C3150 adds a dedicated processor for each band to manage Wi-Fi traffic, freeing up the router's 1.4GHz dual-core CPU to tackle more demanding tasks.

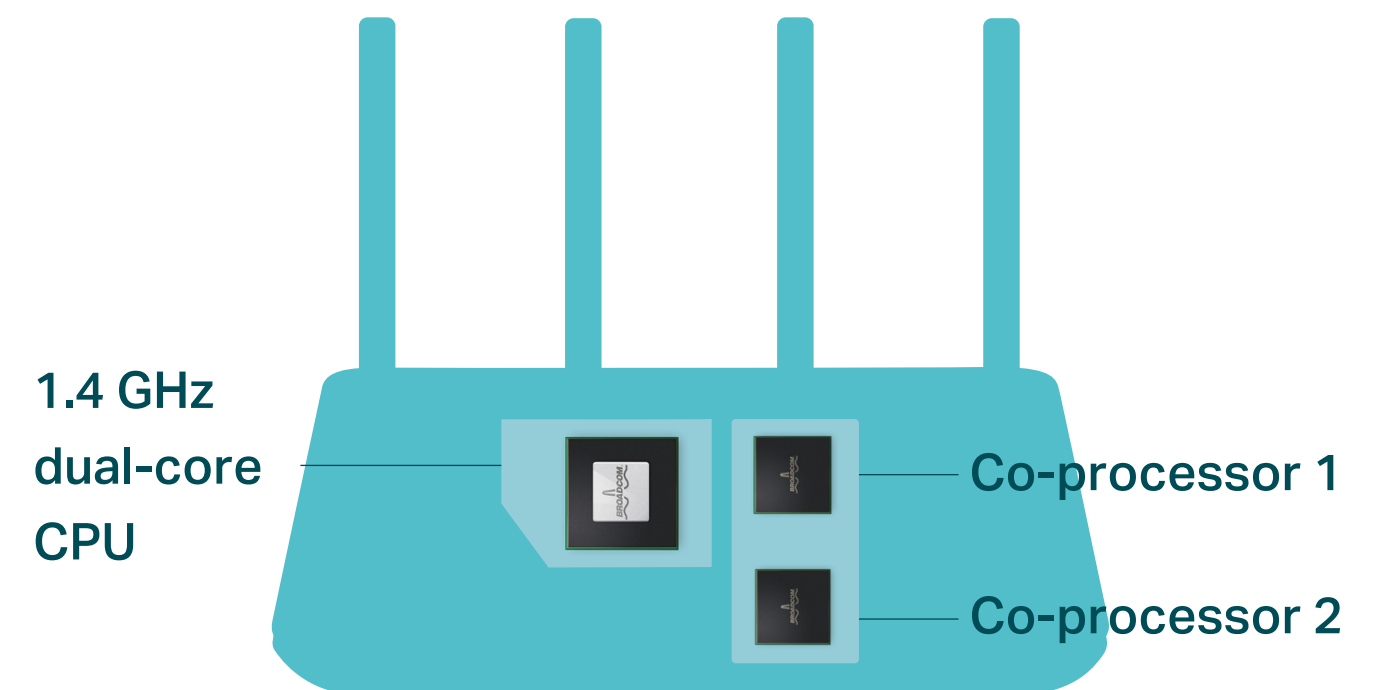

Features



Speed

- **Ultimate Wireless Speed** – Combined wireless speeds of up to 1000 Mbps (over 2.4GHz) and 2167 Mbps (over 5GHz)
- **NitroQAM Technology** – Uses NitroQAM (1024- QAM) modulation scheme for higher data throughput, boosting wireless speeds by up to 25%
- **MU-MIMO Technology** – Simultaneously exchange data with several devices, achieving speeds which are 4x faster than standard AC routers
- **802.11 ac** – Provides a data transfer rate 3 times faster than 802.11n for each stream
- **Dual-core CPU** – 1.4GHz dual-core CPU and 2 co-processors make multi-tasking easy and boost data transfer rate

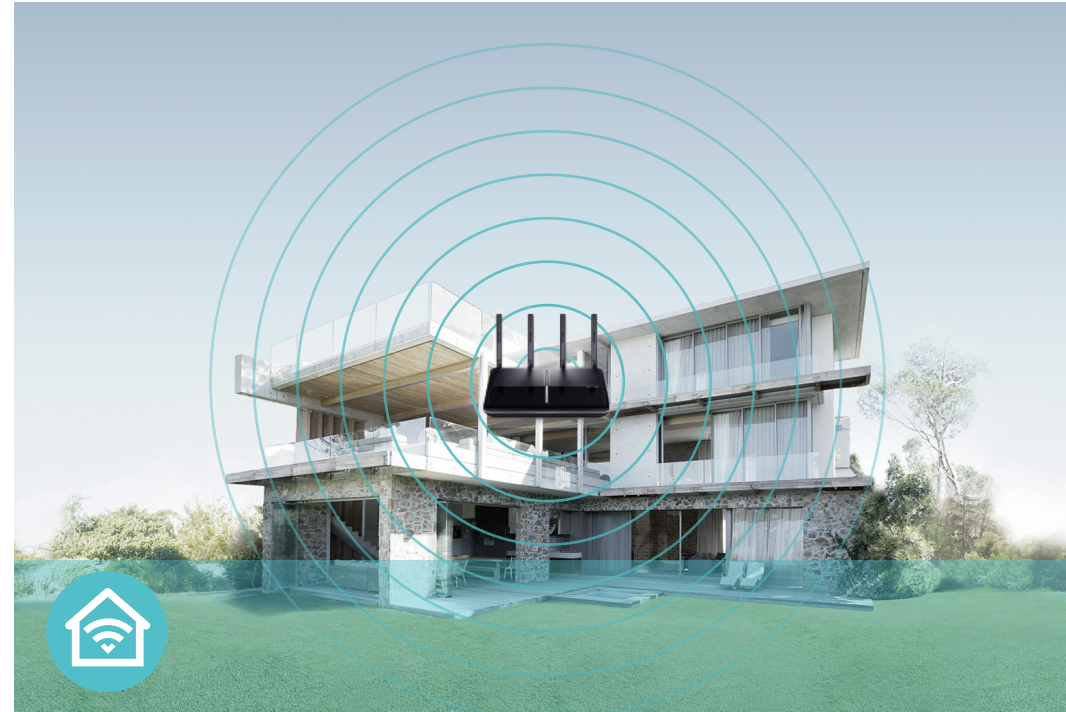

Wi-Fi Range

- **Ultimate Range Wi-Fi** – 4 dual band detachable high-performance antennas with a high-powered amplifier ensure widespread Wi-Fi coverage and a stable connection
- **Wi-Fi with Beamforming** – Beamforming technology locates the connected devices and further improves the Archer C3150's range and the signal strength to each mobile device, delivering a more reliable and efficient wireless connection



Reliability

- **Simultaneous Dual Band** – Separate Wi-Fi bands enable more devices to connect to your network without a drop in performance
- **Easy Bandwidth Management** – IP-based Bandwidth Control makes it easier for you to manage the bandwidth of connected devices
- **Smart Connect Technology** – Dynamic Smart Connect technology automatically selects the optimum band for each device
- **Airtime Fairness** – Balances bandwidth to improve throughput for all connected devices
- **Link Aggregation** – Combines two ports together to make a single high-bandwidth data path for a higher-speed and more stable wired network

Features



Ease of Use

- Intuitive Web UI – Ensures quick and simple installation without hassle
- Fast Encryption – One-touch WPA wireless security encryption with the WPS button
- Easy On/Off – Turn On/Off wireless radio and LEDs separately using the Wi-Fi On/Off and LED On/Off buttons
- Power On/Off – Conveniently power on or off your router as required
- Hassle-free Management with Tether App – Network management is made easy with the TP-Link Tether App, available on any Android or iOS device
- Online Upgrade – Keeps you informed of the latest firmware and allows online updating on the web UI



Security

- Guest Network – Keep your main network secure by creating a separate network for friends and visitors
- Access Control – Establish a whitelist or blacklist to allow or block certain devices from accessing the internet
- Parental Controls – Manage when and how connected devices can access the internet
- VPN Server – PPTP VPN and OpenVPN are supported, making it easy to set up a secure connection between your private network and the internet
- Encryptions for Secure Network – WPA-PSK/WPA2- PSK encryptions provide active protection against security threats

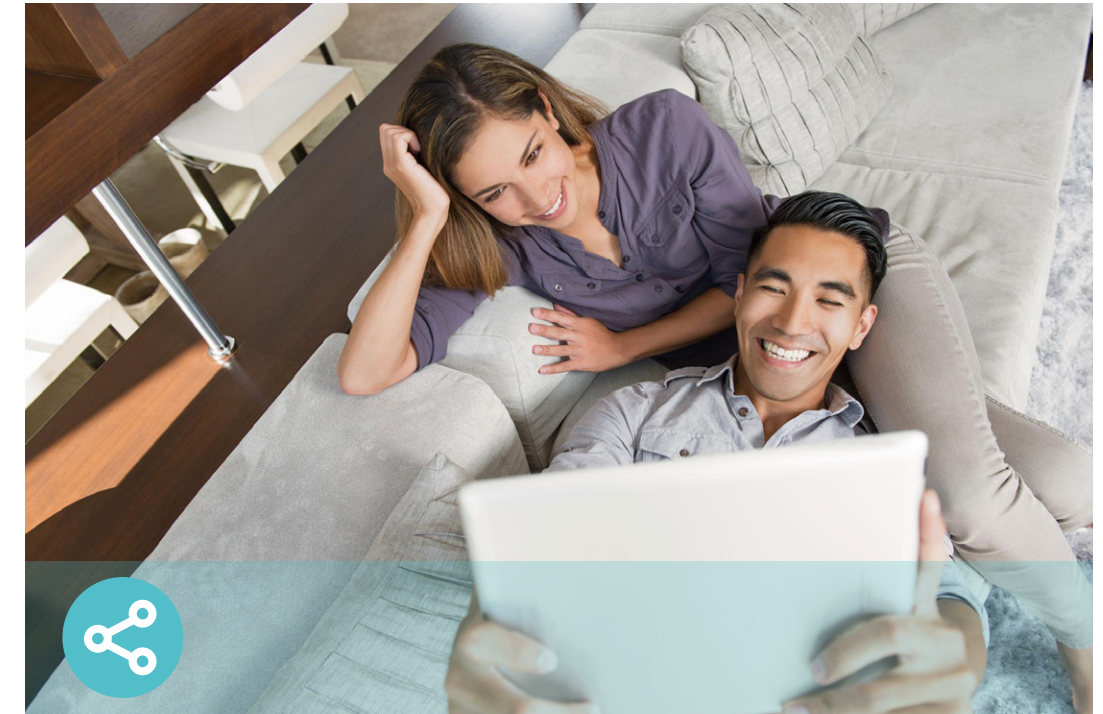

Easy Sharing

- Dual USB Ports for Fast Sharing – With one ultra-fast USB 3.0 port and one USB 2.0 port, you can access and share a printer as well as your files and media locally. Through the router's FTP server, you can also access your files and media from network devices remotely
- 10x Faster Transfer Speed – The USB 3.0 port provides up to 10x faster USB hard drive access than previous generation USB 2.0 connections
- Built-in Print Server – Allows wireless printing from multiple computers (works in conjunction with a USB printer)
- Built-in Media Server – Allows you to play music, watch videos and view photos from any device on your network

Specifications

Hardware

- Ethernet Ports: 4 10/100/1000Mbps LAN Ports & 1 10/100/1000Mbps WAN Port
- USB Port: 1 USB 3.0 Port + 1 USB 2.0 Port
- Button: WPS Button, Reset Button, Wireless On/Off Button, LED On/Off Button, Power On/Off Button
- Antenna: 4 Dual Band Detachable Antennas
- External Power Supply: 12V/5A
- Dimensions (W x D x H): 10.4×7.8×1.5 in. (263.8×197.8×37.3mm)

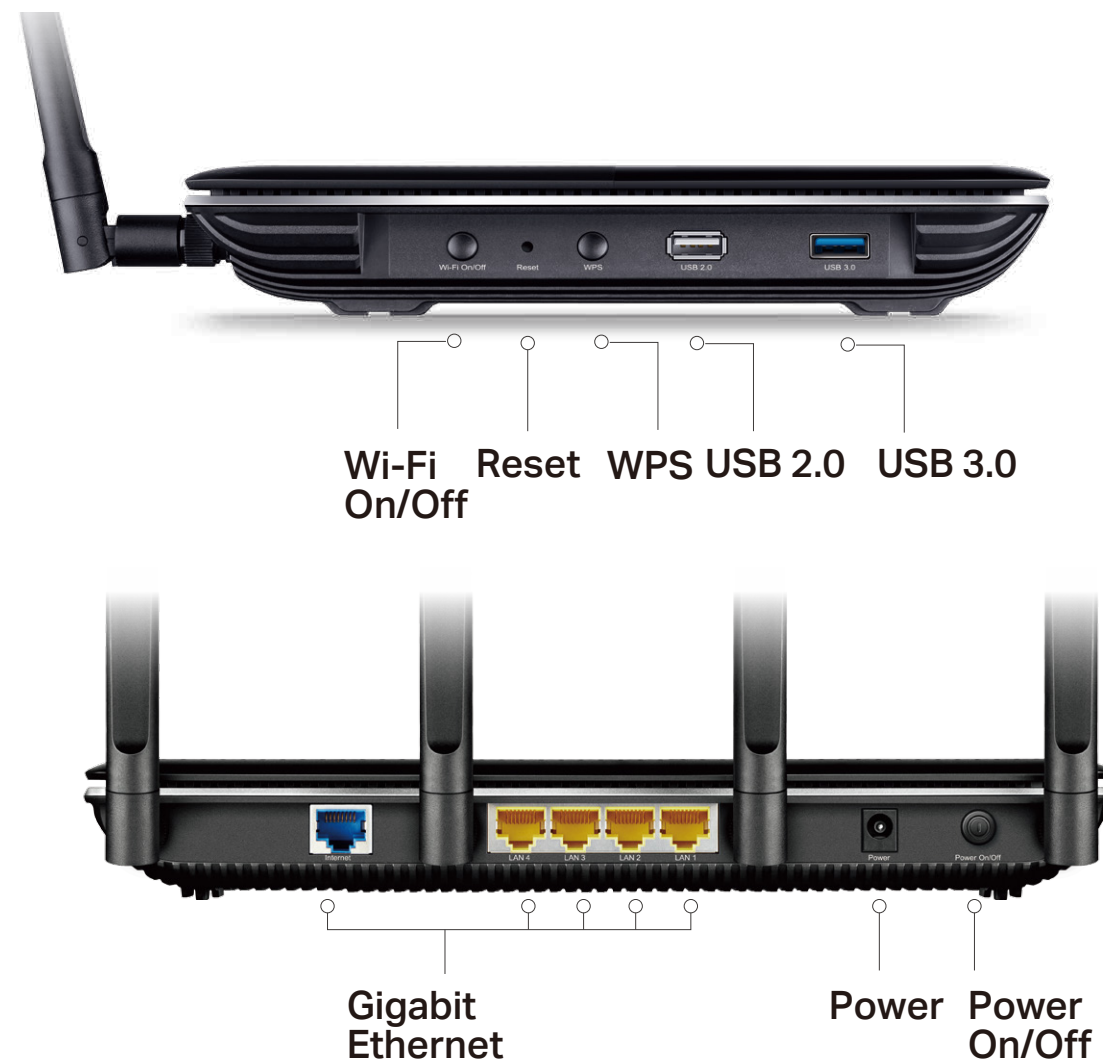

Wireless

- Wireless Standards: IEEE 802.11ac/n/a 5GHz, IEEE 802.11b/g/n 2.4GHz
- Frequency: 2.4GHz and 5GHz
- Signal Rate: 2167Mbps at 5GHz, 1000Mbps at 2.4GHz
- Transmit Power:
CE: <20dBm(2.4GHz), <23dBm(5GHz), FCC: <30dBm
- Reception Sensitivity:
5GHz: 11a 6Mbps: -91dBm
11a 54Mbps: -72dBm
11n HT20: -70dBm
11n HT40: -69dBm
11ac HT20: -60dBm
11ac HT40: -61dBm
11ac HT80: -56dBm
2.4GHz: 11g 54Mbps: -73dBm
11n HT40: -69dBm
- Wireless Function: Enable/Disable Wireless Radio, WMM, Wireless Statistics
- Wireless Security: 64/128-bit WEP, WPA/WPA2, WPA-PSK/WPA-PSK2 encryptions

Specifications

Software

- WAN Type: Dynamic IP/Static IP/PPPoE/PPTP/L2TP
- DHCP: Server, Client, DHCP Client List, Address Reservation
- Quality of Service: WMM, Bandwidth Control
- Port Forwarding: Virtual Server, Port Triggering, UPnP, DMZ
- Dynamic DNS: DynDns, NO-IP
- VPN Server: PPTP VPN, OpenVPN
- Access Control: Parental Controls, Local Management Control
- Firewall Security: DoS, SPI Firewall, IP and MAC Address Binding
- Protocols: Supports IPv4 and IPv6
- USB Sharing: Supports Samba (Storage)/FTP Server/Media Server/Print Server
- Management: Access Control, Local Management, Remote Management
- Guest Network: 2.4GHz guest network x 1, 5GHz guest network x 1

Others

- Certification: CE, FCC, RoHS
- System Requirements:
 - Microsoft Windows 98SE, NT, 2000, XP, Vista™ or Windows 7, 8, 8.1, 10, Mac OS, NetWare, UNIX or Linux
 - Internet Explorer 11, Firefox 12.0, Chrome 20.0, Safari 4.0, or other Java-enabled browser
 - Cable or DSL Modem
 - Subscription with an internet service provider (for internet access)
- Environment
 - Operating Temperature: 0°C~40°C (32°F ~104°F)
 - Storage Temperature: -40°C~70°C (-40°F ~158°F)
 - Operating Humidity: 10%~90% non-condensing
 - Storage Humidity: 5%~90% non-condensing
- Package Contents
 - AC 3150 Wireless MU-MIMO Gigabit Router Archer C3150
 - 4 Detachable Antennas
 - Power Supply Unit
 - Ethernet Cable
 - Quick Installation Guide



For more information, please visit

<http://www.tp-link.com/en/products/details/?categoryid=&model=Archer+C3150>

or scan the QR code left

Specifications are subject to change without notice. TP-Link is a registered trademark of TP-Link Technologies Co., Ltd. Other brands and product names are trademarks or registered trademarks of their respective holders. No part of the specifications may be reproduced in any form or by any means or used to make any derivative such as translation, transformation, or adaptation without permission from TP-Link Technologies Co., Ltd.

Maximum wireless speed of up to 3150Mbps is the theoretical data rate derived from IEEE standard 802.11 specifications. Actual data throughput and wireless coverage will vary due to network conditions and environmental factors including volume of network traffic, building materials and construction, network overhead, actual data throughput rate, and wireless coverage. TP-Link makes no express or implied representations or warranties about this product's compatibility with any future standards. 802.11ac 1300Mbps is approximately 3 times faster than 802.11n 450Mbps. 2.4GHz Performance Mode requires 256 QAM support on Wi-Fi client.

www.tp-link.com

TP-Link AC3150 Wireless MU-MIMO Gigabit Router Archer C3150