

Wall Mounting

1 Drill Holes

- Place the paper drill guide where you want the camera. Check the alignment using a level. Using a(n) 0.24 inch (6mm) drill bit, drill holes through the two circles on the guide. Remove the paper.

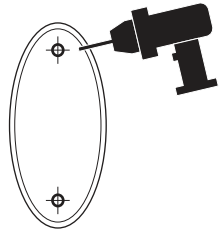

2 Mount Base

- Insert the two anchors into the holes and place the camera mount over the anchor.

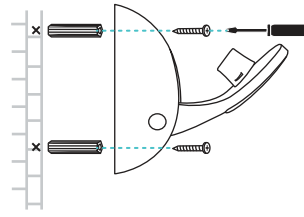

3 Secure Camera

- Attach the camera and use the screws to secure it.

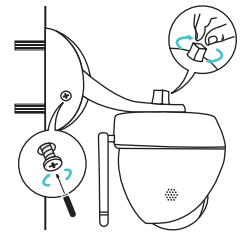

Ceiling Mounting

1 Drill Holes

- Place the paper drill guide where you want the camera*. Using a(n) 0.24 inch (6mm) drill bit, drill holes through the two circles on the guide. Remove the paper.

* Camera placement can affect viewing angle. For best results, place the camera near a wall or corner.

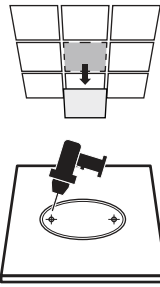

- Attach the camera mount using the screws, washers, and wingnuts.

2 Mount Base

- Attach the camera and use the screws to secure it.

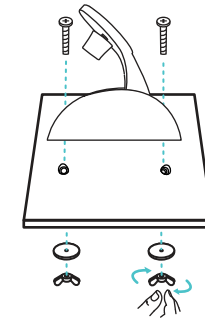

3 Secure Camera

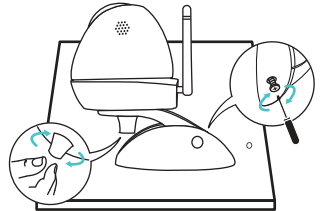

Quick Installation Guide

1 Connect

Connect the NC450 and your smartphone to the same router, then connect the power cord and internet cord to the NC450. If the cord is long enough, please use **Method A** below. If not, use a Passive PoE Injector to connect, as shown in **Method B**.

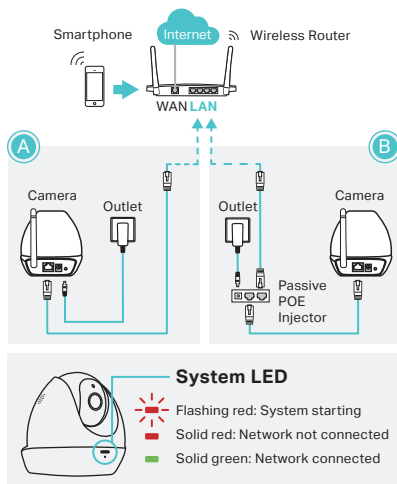

2 Register

Download the **tpCamera** app. Once installed, open it and follow the instructions to add the camera to your TP-Link ID.



OR



3 Relocate

Place the camera where you want it. You can place it on a flat surface, or mount it as shown on the back of this guide.

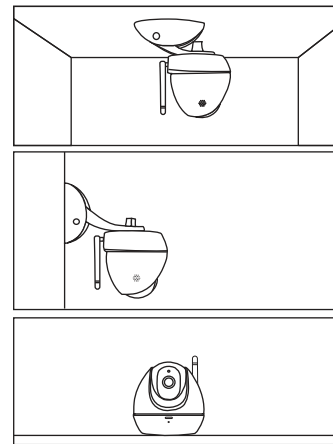

4 View and Enjoy

View live video using the **tpCamera** app or TP-Link Cloud website.

Via **tpCamera**: On the "My Cam" screen, tap your camera to view video. Change the camera angle using the pan and tilt controls.

Via TP-Link Cloud website: Log in at <https://www.tplinkcloud.com> and select your camera to view live video.

More functions with tpCamera

- Get notifications when motion is detected, and view alerts history.
- Stay in touch with 2-way audio.

View all of your cameras on one screen by downloading the TP-Link Camera Control utility. See the Camera Control User Guide for more details. Or visit us online at www.tp-link.com for Camera Control utility, Firmware, and other support.

The WPS/Reset Button

WPS (Wi-Fi Protected Setup): If your Wi-Fi router supports WPS, you can connect the camera to your Wi-Fi network using WPS. For details, see the camera's User Guide.

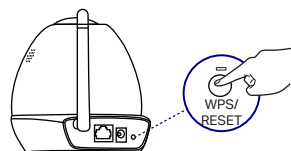

Short Press to trigger WPS; Press and hold for 5 seconds to trigger Reset.

Mounting Kit

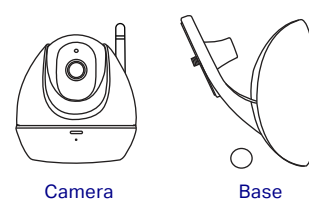

Camera

Base

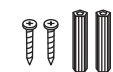

Wall mount kit

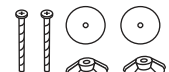

Ceiling mount kit

tp-link.com

Cover any angle from anywhere