

# Quick Installation Guide

Applicable Models:

**TL-WA850RE & TL-WA750RE** **EAC**

**WPS** Option ONE: Quick Setup using the WPS Button

**Option TWO:** Setup using your Web Browser

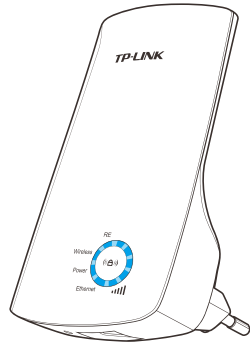

7106505291 REV2.0.0

## Wireless

**Blinking:** The wireless function is working properly.

## Power

**On:** The Range Extender is on.

## Ethernet

**On:** The Ethernet port is connected.

**Blinking:** The Ethernet port is transmitting data.

**Off:** The Ethernet port is not connected.

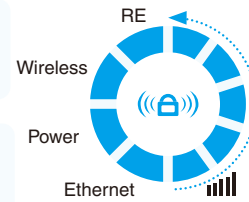

## RE

**On:** The Range Extender is connected to your router.

**Blinking:** The Range Extender is establishing a connection with your router.

**Off:** The Range Extender is not connected to your router.

**Signal Strength**

**On:** The number of lit LEDs indicates the strength of wireless signal.

**Blinking:** A connection to your router has been established, but no Internet access yet.

**Off:** The Range Extender is not connected to your router.

## Option ONE

### Quick Setup using the WPS Button

Your router must support WPS

## 1 Power on

Plug in next to your Router.

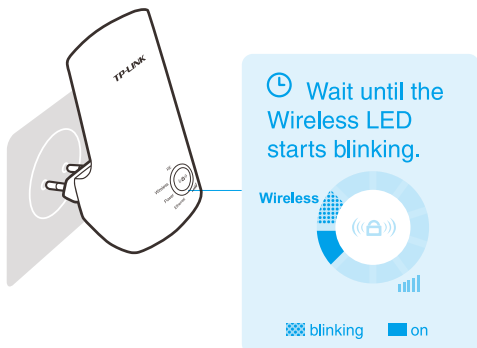

## 2 Connect

① Press the WPS button.

② Press the «A» button.

③

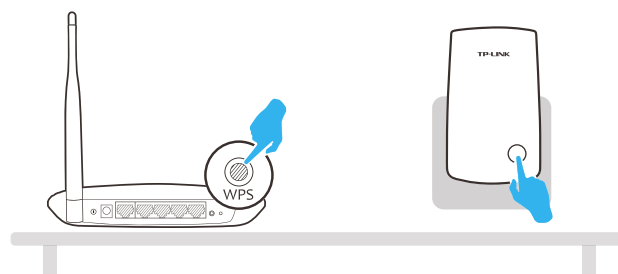

The RE LED should go from blinking to solid 'on'.



④ If the RE LED does not go from blinking to solid 'on', please use Option TWO.

## 3 Relocate

After the extender is relocated to a new place, the extender will reconnect to your router automatically in about one minute.

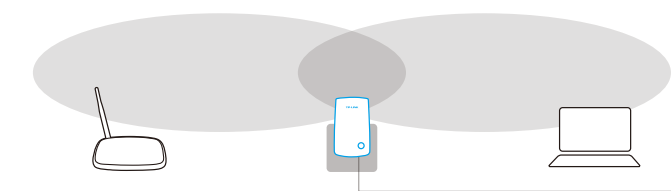

The ideal location for your extender is **halfway** between your wireless router and wireless devices.



Make sure your extender is in a location where a minimum of **3 signal strength LEDs** are lit.



Keep the extender away from devices like cordless phones, Bluetooth devices and microwave ovens to minimize wireless interference.

If possible, try to place your extender in **open corridors** or **spacious locations** rather than a crowded room.

## Enjoy!

The Range Extender **shares** your router's **Wireless Network Name (SSID)** and **Wireless Password**.

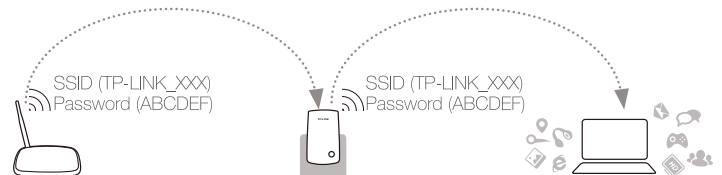

## Frequently Asked Questions (FAQ)

### Q1. What should I do if my router doesn't have a WPS button?

A: Please use **Option TWO** to set up the Range Extender.

### Q3. Why doesn't the RE LED light up after I finish Option TWO?

A: You may have typed in the wrong wireless password for your router. Please reset the Range Extender, double check your router's wireless password and set up the Range Extender again.

### Q2. Why can't I see the login page after entering <http://tplinkrepeater.net> in the browser?

A: First, make sure your computer is connected to the extender network and disconnected from any other network. Second, make sure your computer is set to **Obtain an IP address automatically**.

### Q4. How do I reset the Range Extender?

A: While the Range Extender is plugged in, use a pin to press the **RESET** button until all the LEDs flash once.

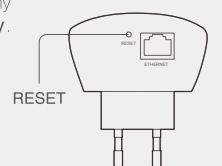

## Option TWO

## Setup using your Web Browser

# 1

### Power on

Plug in next to your Router.

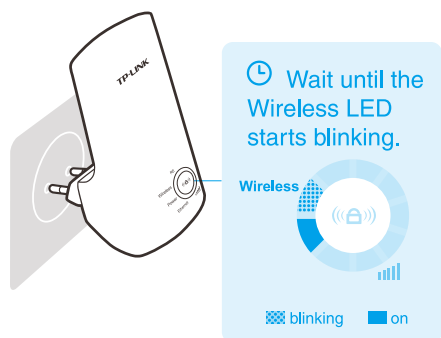

# 2

### Connect your computer to the TL-WA850RE

Connecting via **Ethernet Cable**

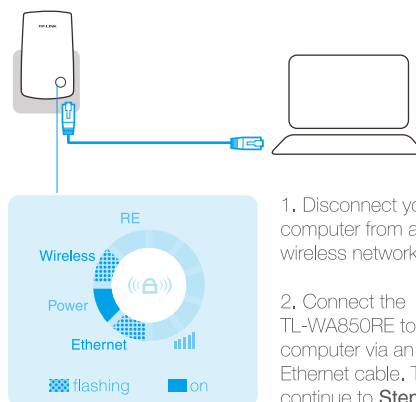

Connecting via **Wireless**

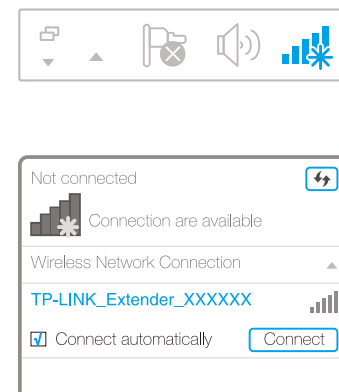

# 3

### Configure

1 Type "http://tplinkrepeater.net" in your Web browser and press **Enter**. Log in to the management page using username "admin" and password "admin".

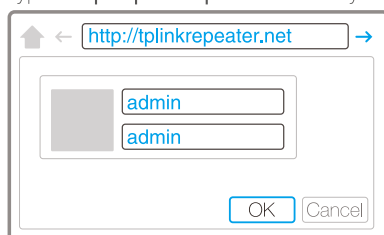

It may take 5 seconds or more for the login page to pop up. If it does not pop up, refresh the browser, otherwise, please refer to the FAQ > Q2.

2 Below are the major steps of the setup process.



a. After logging in, you will see the **Quick Setup** page.

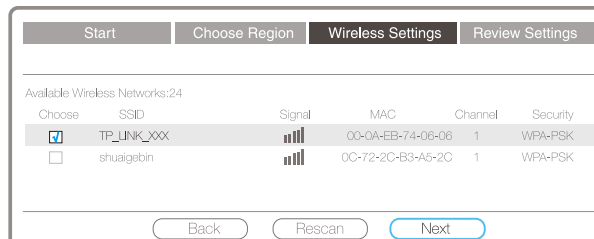

b. Select your Router/AP's **Wi-Fi** network, for example, **TP\_LINK\_XXX**.

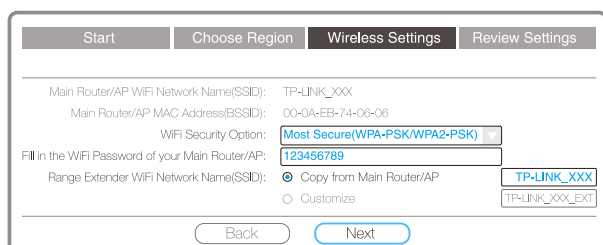

c. Fill in the **Wi-Fi Password** of your main Router/AP. The TL-WA850RE's **Wi-Fi network name (SSID)** can be copied from your main Router/AP name (TP-LINK\_XXX) OR BE CUSTOMIZED A NEW ONE (TP-LINK\_XXX\_EXT).

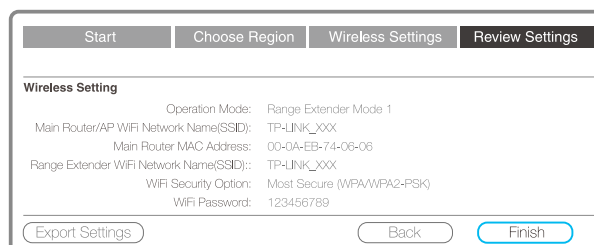

d. Review the settings, especially the **WiFi** password. Click **Finish** if the settings are correct.



# 4

### Relocate

Please refer to **Step 3** of **Option ONE**.

## Enjoy!

The Range Extender shares your router's wireless password, but may have a different wireless network name.

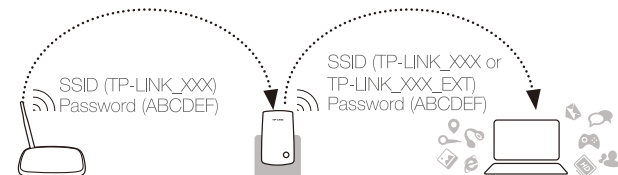

## Entertainment Adapter

The Range Extender can be used as a wireless adapter to connect to an Ethernet device, like a Blu-ray player, a game console, a DVR, or a smart TV to a wireless network. Please follow **Option ONE** or **Option TWO** to set up the Range Extender first and then connect an Ethernet device according to the diagram on the right.

