

Multi-mode Router

Meet all your needs.

TL-WR940N

Router Mode

If your internet connection is through an Ethernet cable from the wall, instead of through a modem, connect the Ethernet cable directly to the router's Internet port, and skip Step 1,2,3.

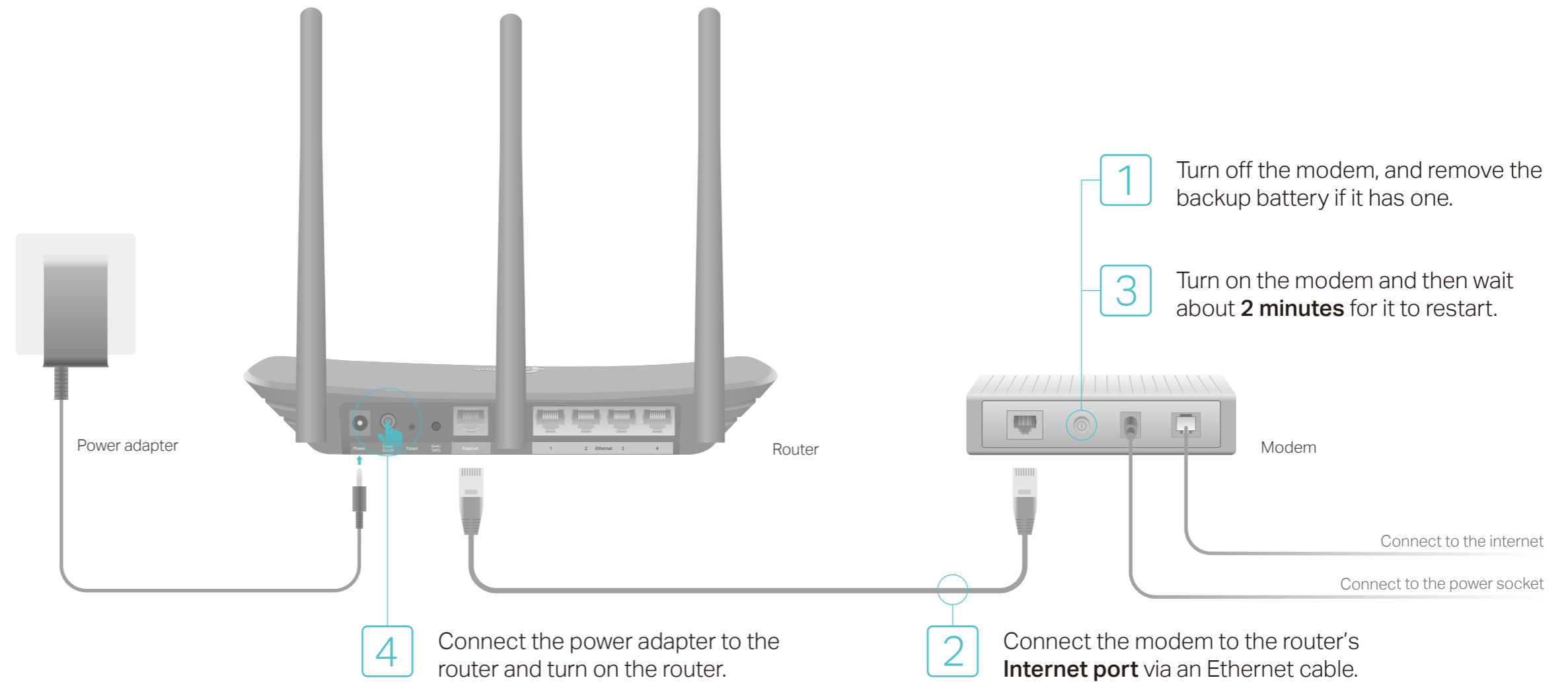

5 Confirm that the following LEDs are on and solid to verify that the hardware connection is correct.



Note: If the Wi-Fi LED is off, please press and hold the Wi-Fi/WPS button on the rear panel of the router until it is on.

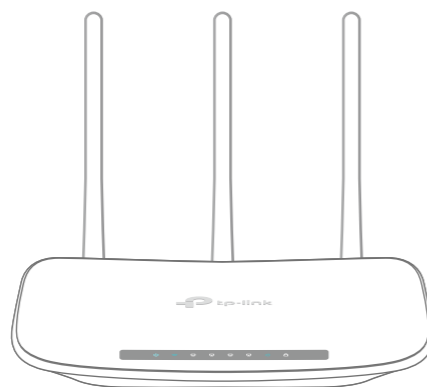

6 Configure the router

1. Connect your computer to the router (Wired or Wireless)

Wired

Turn off the Wi-Fi on your computer and connect it to the router via an Ethernet cable.

Wireless

Connect your device to the router's Wi-Fi using the SSID (Network Name) and Wireless Password printed on the label at the bottom of the router.



2. Configure the router using a web browser

A Launch a web browser, and enter <http://tplinkwifi.net> or <http://192.168.0.1> in the address bar. Use **admin** for both username and password, and then click **Login**.

Note: If the login window does not appear, please refer to FAQ > Q1.

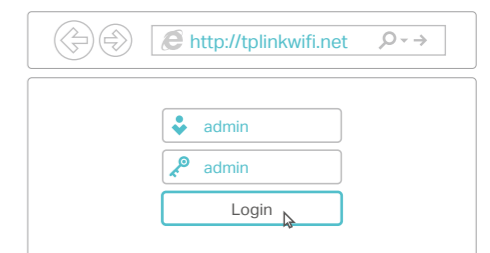

B Click **Next** to start the Quick Setup. Select **Standard Wireless Router** and follow the step-by-step instructions of the Quick Setup to complete the initial configuration.

Note: If you are not sure of the WAN Connection Type, please click **Auto-Detect**.

Enjoy!

Repeater Mode

In Repeater mode, the router boosts the existing wireless coverage in your home.

1. Configure

- Place the router next to your host router and turn it on.
- Connect a computer to the router via an Ethernet cable or wirelessly by using the SSID (Network Name) and Wireless Password printed on the label at the bottom of the router.
- Launch a web browser and enter <http://tplinkwifi.net> in the address bar. Use **admin** for both the username and password, and then click **Login**.

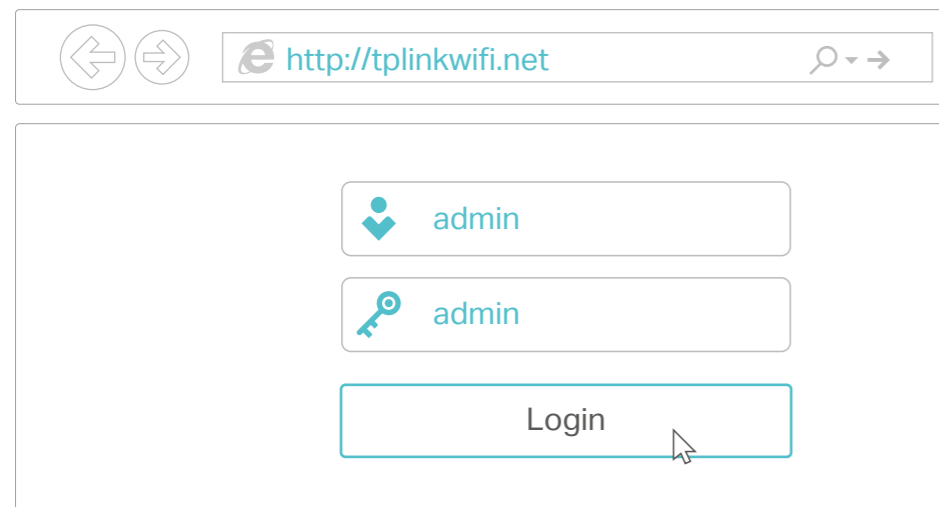

- Click **Next** to start the Quick Setup. Select **Repeater** and follow the step-by-step instructions of the Quick Setup to complete the initial configuration.

Note: Click **Survey** to find your host network you want to connect to, and then enter its wireless password.

FAQ (Frequently Asked Questions)

Q1. What can I do if the login window does not appear?

- If the computer is set to a static or fixed IP address, change the setting to obtain an IP address and DNS server address automatically.
- Verify that <http://tplinkwifi.net> or <http://192.168.0.1> is correctly entered in the web browser. Alternatively, enter <http://192.168.1.1> in the web browser and press **Enter**.
- Use another web browser and try again.
- Reboot your router and try again.
- Disable and then enable the network adapter being used.

Q2. What can I do if I cannot access internet when using Router mode?

- Check if the internet is working normally by connecting a computer directly to the modem using an Ethernet cable. If it is not, contact your Internet Service Provider.
- Log in to the web management page of the router, and go to the **Status** page to check whether the WAN IP address is valid or not. If it is, please run the Quick Setup again; otherwise, recheck the hardware connection.
- Reboot your router and try again.
- For cable modem users, log in to the web management page of the router. Go to **Network > MAC Clone**, select **Clone MAC Address** and click **Save**. Then reboot both the modem and the router.

2. Relocate

Place the router about halfway between your host router and the Wi-Fi “dead” zone. The location you choose must be within the range of your existing host network.

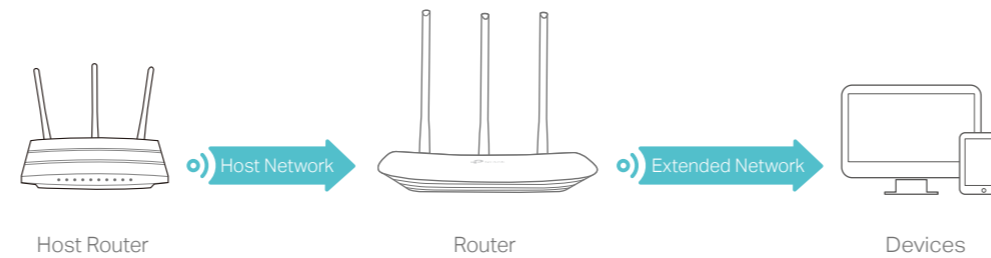

The extended network shares the same **SSID (network name)** and **password** as those of your host network.

Access Point Mode

In Access Point mode, the router transforms your existing wired network to a wireless one.

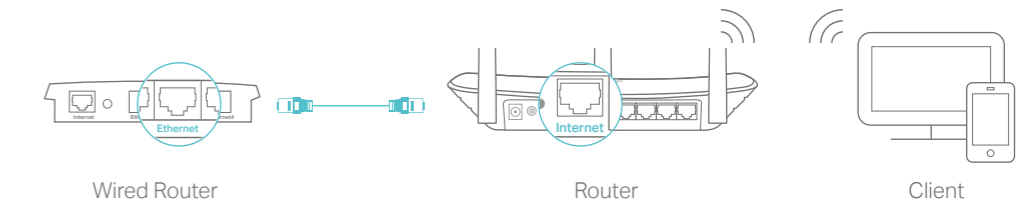

- Turn on the router.
- Connect the router to your wired router's Ethernet port via an Ethernet cable as shown above.
- Connect a computer to the router via an Ethernet cable or wirelessly by using the SSID (Network Name) and Wireless Password printed on the label at the bottom of the router.
- Launch a web browser and enter <http://tplinkwifi.net> in the address bar. Use **admin** for both the username and password to log in.
- Click **Next** to start the Quick Setup. Select **Access Point** and follow the step-by-step instructions of the Quick Setup to complete the initial configuration.



Connect to the wireless network by using the **SSID (network name)** and **password** of the router.

Tether App

The TP-LINK Tether app provides a simple, intuitive way to access and manage your router.



Block unwelcome users from connecting to your network



View information about clients connected to your router



Change the basic wireless network settings



Set up Parental Controls with access time

How to begin?

- Download the TP-LINK Tether app from the Apple App Store or Google Play Store.
- Ensure your smart device is wirelessly connected to the home network.
- Launch the Tether app and start managing your home network.



Scan to download