

Quick Installation Guide

Mobile Wi-Fi

* Images are for demonstration only.

Screen Display

Home Screen

Press to enter the menu screen.

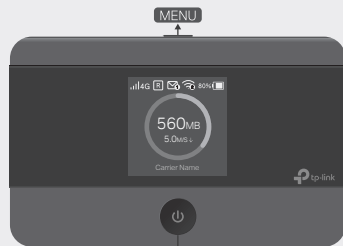

Press to turn on or off the screen display.

Menu Screen

Press to switch between icons.

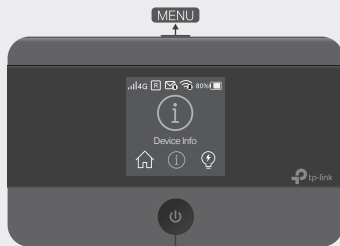

Press to select an icon.

- 1 The screen display will automatically turn off after being idle for a while. To turn it on again, press the **⏻** or **MENU** button.

1. Install the SIM Card and Battery

a. Remove the back cover.

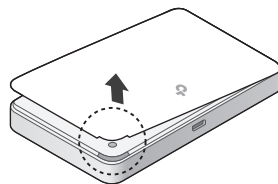

b. Install your SIM card.

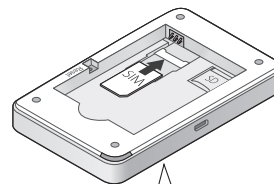

c. Install the provided battery.

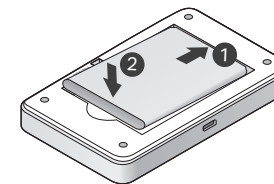

d. Replace the back cover.

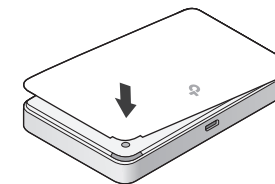

1 SIM card requirement:



Standard SIM card



Micro SIM card + Provided Micro SIM card adapter + Provided sticker



Nano SIM card + Provided Nano SIM card adapter + Provided sticker

- 1 If you have a micro SD card, you can insert it into the SD card slot for storage and media sharing.

2. Connect to the Internet

a. Power on the Mobile Wi-Fi.

Press and hold the Power button **⏻** until the welcome screen appears.



b. Connect your smart device to the Mobile Wi-Fi.

To view the SSID and password, press the **MENU** button to switch to the **Device Info** icon, then press the Power button **⏻** to enter the screen.

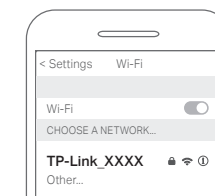
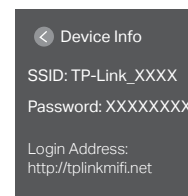

😊 Enjoy the internet!



- 1 If you cannot access the internet, refer to **FAQ > Q1**.
- By default, Power Saving is enabled and the Mobile Wi-Fi will turn off Wi-Fi when no wireless devices are connected to it for 10 minutes. To resume the Wi-Fi connection, press the **⏻** or **MENU** button.

Managing Your Mobile Wi-Fi

Manage your Mobile Wi-Fi using any of the methods below. You can customize Wi-Fi settings, block Wi-Fi devices and more.

tpMiFi App

1. Get the **tpMiFi** app from App Store or Google Play, or by scanning the QR code.



2. Connect your wireless device to the Mobile Wi-Fi.
3. Launch the **tpMiFi** app and enter **admin** to log in.

Web Management Page

1. Connect your wireless device to the Mobile Wi-Fi. If it is a computer, make sure it is set to obtain an IP address automatically.
2. Launch a web browser and visit <http://tplinkmifi.net> or <http://192.168.0.1>. Enter **admin** to log in.

-  For technical support, the user guide and other information, please visit <https://www.tp-link.com/support>.



Charging Your Mobile Wi-Fi

Method 1

Via a Wall Outlet (Recommended)

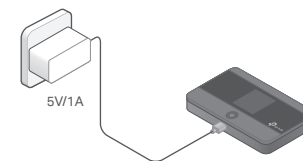

Method 2

Via a Computer

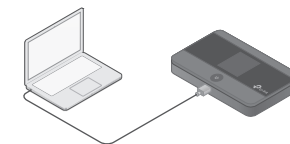

- When  on the battery icon disappears, the Mobile Wi-Fi is fully charged.
- The power adapter is not provided by TP-Link.

FAQ (Frequently Asked Questions)

Q1. What should I do if I cannot access the internet (one of the following messages appears on the home screen)?

A1. PIN Required

- Your SIM card is PIN protected. Visit the web management page (<http://tplinkmifi.net>) on your phone, enter **admin** to log in, then enter the PIN provided by your mobile carrier.

A2. No SIM Card

- Power off the Mobile Wi-Fi and reinstall your SIM card.

A3. No Service

- Verify that your SIM card is an LTE, WCDMA, or GSM SIM card.
- Verify that your SIM card is in your carrier's service area and has sufficient credit.
- Visit the web management page (<http://tplinkmifi.net>) on your phone, and enter **admin** to log in. Go to **Dial-up**, tap **View profile details**, and verify that the parameters (i.e. APN, username and password) provided

by your mobile carrier are correct. If they are not correct, return to the **Dial-up** page and create a new profile with the correct information.

A4. icon

- Enter the Menu screen, go to **Data Roaming**, and turn on **Data Roaming**.

Q2. How do I restore the Mobile Wi-Fi to its factory default settings?

- A. With the Mobile Wi-Fi powered on, remove the cover, then use a pin to press and hold the Reset button until "**Power Off**" appears on the screen.

Note: Restoring the device to its factory defaults will clear all your settings.

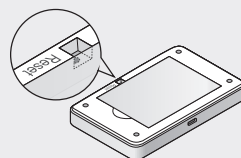

Safety Information

- Keep the device away from water, fire, humidity or hot environments.
- Do not attempt to disassemble, repair, or modify the device. If you need service, please contact us.
- Do not use the device where wireless devices are not allowed.
- Do not disassemble, crush, puncture, short external contacts, or dispose of the battery in fire or water.
- Do not leave a battery in an extremely high temperature surrounding environment that can result in an explosion or the leakage of flammable liquid or gas. Do not leave a battery subjected to extremely low air pressure that may result in an explosion or the leakage of flammable liquid or gas.

CAUTION: RISK OF EXPLOSION IF BATTERY IS REPLACED BY AN INCORRECT TYPE.

Please read and follow the above safety information when operating the device. We cannot guarantee that no accidents or damage will occur due to improper use of the device. Please use this product with care and operate at your own risk.