

ATTENTION

- ◆ When product has power button, the power button is one of the way to shut off the product; when there is no power button, the only way to completely shut off power is to disconnect the product or the power adapter from the power source.
- ◆ Don't disassemble the product, or make repairs yourself. You run the risk of electric shock and voiding the limited warranty. If you need service, please contact us.
- ◆ Keep the device away from water, fire, humidity or hot environments.

Recycling

 This product bears the selective sorting symbol for Waste electrical and electronic equipment (WEEE). This means that this product must be handled pursuant to European directive 2012/19/EU in order to be recycled or dismantled to minimize its impact on the environment. User has the choice to give his product to a competent recycling organization or to the retailer when he buys a new electrical or electronic equipment.



To communicate with TP-Link users or engineers, please visit <https://community.tp-link.com> to join TP-Link Community.



For technical support, replacement services, the user guide and more information, please visit <https://www.tp-link.com/support>, or simply scan the QR code.



If you have any suggestions or needs for our product guides, you are welcome to email techwriter@tp-link.com.cn.

Using the Adapter

This adapter supports Plug and Play feature. Plug in and wait for seconds. Then this adapter is ready to use.

* UE300C:

For Windows 7/8/8.1, Mac OS X 10.8 and older version, please download and install a driver from our official website: www.tp-link.com, and search the model number.

* UE330, UE300 and UE200:

For Windows 7/8/8.1, please click to install a driver if prompted to do so. For Windows 7, please click CANCEL if prompted "The program might not have installed correctly" after installation.

For Mac OS X 10.8 and older version, please download and install a driver from our official website: www.tp-link.com, and search the model number.

* UE305:

For Windows 7/8 and Mac OS, please download and install a driver from our official website:

www.tp-link.com, and search the model number.

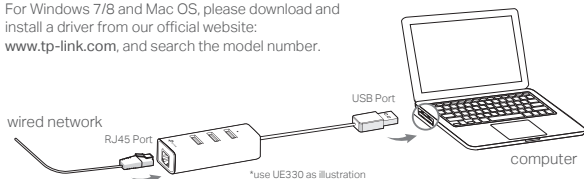

* Works with Nintendo Switch (Supported by UE305 ONLY)

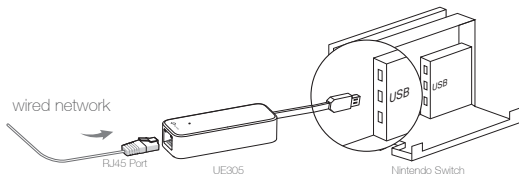

LED Explanation

LED (for UE330)	Status	Indication
White	On	The adapter is properly connected and hub is ready to use
Yellow	On	The Ethernet cable is properly connected
Green	Flashing	Network data is being transferred

LED (for UE300C, UE300, UE200, UE305)		
White	On	Both the adapter and Ethernet cable are properly connected
White	Flashing	Network data is being transferred