



Quick Installation Guide

4G LTE Mobile Wi-Fi
M7350

Install the SIM Card and Battery

1 Remove the back cover.

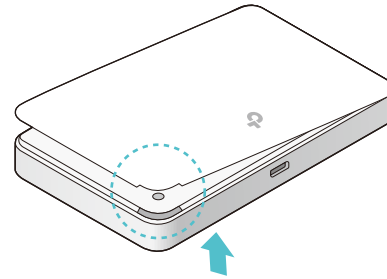

2 Insert the SIM card.

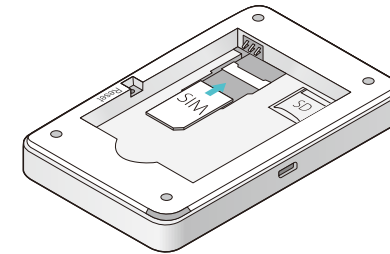

- Nano and micro SIM cards must be converted using the provided SIM card tray.
- The SD card slot can be used for storage and media sharing.
- The SIM card and SD card are not provided.

3 Install the provided battery.

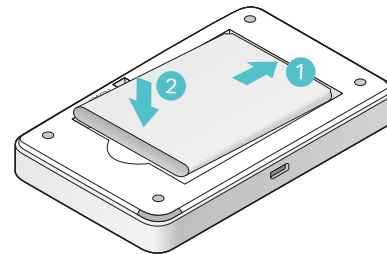

4 Replace the cover.

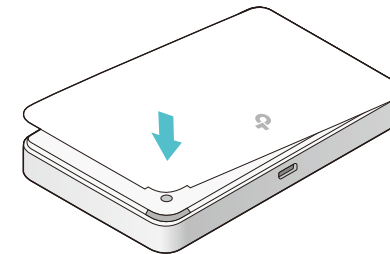

Connect to the Internet

1 Press and hold the  button until the welcome screen appears.



- To power off, press and hold the  button until "Power Off" appears.

2 You will find the following messages on the screen. Follow the instructions to connect to the Mobile Wi-Fi.

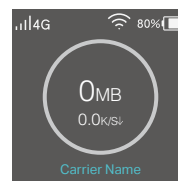

Press the **MENU** button twice and then press the  button to select **Device Info**. Use the **SSID** and **Password** shown on the screen to connect to your Mobile Wi-Fi.

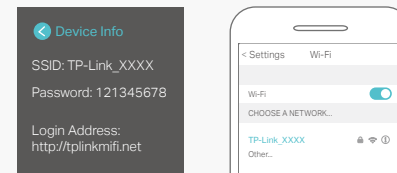

Enjoy!



- If other messages display on the screen, please refer to FAQ > Q3.
- By default, Power Saving is enabled and the Mobile Wi-Fi will turn off the Wi-Fi connection if no wireless devices are connected to the Mobile Wi-Fi for 10 minutes. Press the  or **MENU** button to resume the Wi-Fi connection.

Screen Display

The screen display will automatically turn off after being idle for 15 seconds. Press the or **MENU** button to turn it on again.

Home Screen

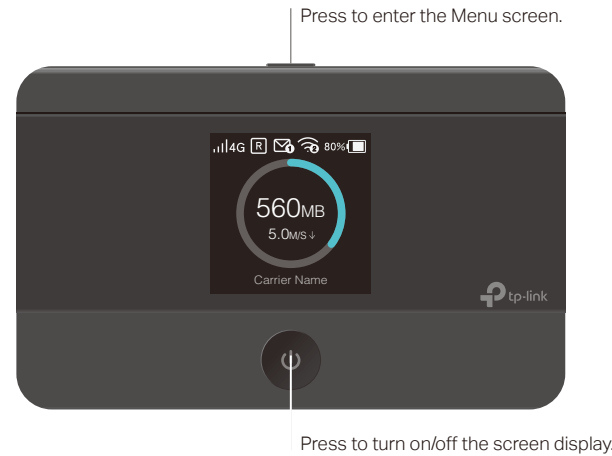

- Signal Strength
- Wi-Fi Status and Connected Wi-Fi Devices
- Network Type and Internet Connection
- Battery Life
- Data Roaming
- Cumulative Data Usage
- Message
- Download Speed

Menu Screen

Select the icons to access the various functions of the Mobile Wi-Fi. You can view and change settings on the corresponding screen.

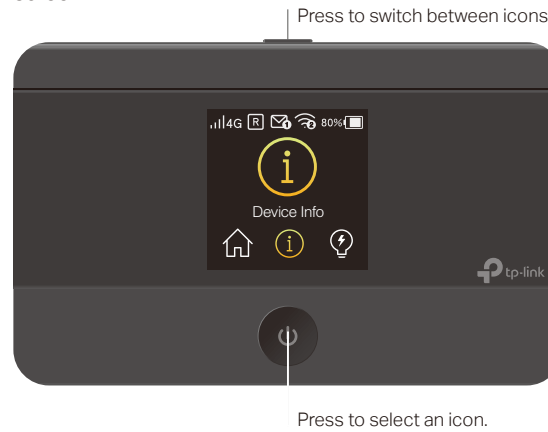

- Home
- WPS
- Device Info
- Wi-Fi Band
- Power Saving
- Network Mode
- Data Roaming
- App Download

tpMiFi App

Download the tpMiFi App (for iOS and Android) to conveniently manage your Mobile Wi-Fi.

- Modify Wi-Fi settings
- Send and receive SMS
- Manage power
- Share files on the SD card
- Block devices

How to download?

- Download the tpMiFi App from the Apple App Store or Google Play Store.
- Connect your wireless device to the Mobile Wi-Fi.
- Launch tpMiFi and enter **admin** to log in.



Charging Your Mobile Wi-Fi

Method 1

Via a Wall Outlet (Recommended)

Method 2

Via a Computer

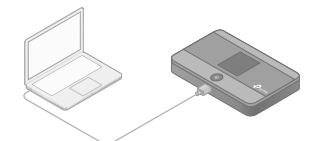
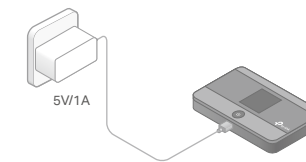

- When the lightning bolt on the battery icon disappears, the Mobile Wi-Fi is fully charged.
- The power adapter is not provided by TP-Link.

FAQ (Frequently Asked Questions)

Q1. Is there an alternative way to manage the Mobile Wi-Fi besides the tpMiFi app?

- A. You can manage the Mobile Wi-Fi by using its web management page.
- Connect your wireless device to the Mobile Wi-Fi.
 - Launch a web browser and enter <http://tplinkmifi.net> or <http://192.168.0.1> into the address bar. Enter **admin** for the Password, and then click Login.

Q2. What should I do if I cannot log in to the web management page?

- Verify that your device is connected to the Mobile Wi-Fi.
- Verify that you have entered <http://tplinkmifi.net> or <http://192.168.0.1> correctly.
- Verify that your device is set to obtain an IP address automatically.

Q3. What should I do when one of the following messages appears on the screen or I cannot access internet?

A1. PIN Required

- Log in to the web management page. Enter the PIN according to your mobile carrier, and click **Done**.

A2. No SIM Card

- Power off the Mobile Wi-Fi and reinstall the SIM card.

A3. No Service

- Verify that your SIM card is an LTE, WCDMA or GSM SIM card;
- Verify that your SIM card is in your carrier's service area and has sufficient credit;
- Verify that your carrier parameters are correct:

On your phone, log in to the web management page, and go to **Dial-up > View profile details** to verify if APN (Access Point Name), Username and Password are correct. If they are not, return to the **Dial-up** page and create a new profile with the correct information. Then click **Done** and confirm at the prompt.

A4. icon

- From the Menu screen, go to **Data Roaming** and turn on **Data Roaming**.

Q4. What should I do if my internet speed is slow?

A1. If you are experiencing intermittent slow internet, you can switch between 2.4GHz and 5GHz bands for better connectivity. From the Menu screen, go to **Wi-Fi Band** and try a different frequency.

A2. The 4G network may be temporarily unavailable in your current location. From the

Menu screen, go to **Network Mode** and try a different network.

Q5. How do I restore the Mobile Wi-Fi to its factory default settings?

A. With the Mobile Wi-Fi powered on, remove the cover, and use a pin to press and hold the **RESET** button until **"Power Off"** appears on the screen.

Note: Restoring the Mobile Wi-Fi to its factory defaults will clear all previous settings and you will need to reconfigure it.

Safety Information

- Keep the device away from water, fire, humidity or hot environments.
- Do not attempt to disassemble, repair, or modify the device.
- Do not use damaged charger or USB cable to charge the device.
- Do not use any other chargers than those recommended.
- Do not use the device where wireless devices are not allowed.

CAUTION: RISK OF EXPLOSION IF BATTERY IS REPLACED BY AN INCORRECT TYPE. DISPOSE OF USED BATTERIES ACCORDING TO THE INSTRUCTIONS.

Please read and follow the above safety information when operating the device. We cannot guarantee that no accidents or damage will occur due to improper use of the device. Please use this product with care and operate at your own risk.

