

# Quick Installation Guide

AC1200 Wireless Dual Band Router

Archer C50

7106506176 REV2.0.2

## Connecting the Hardware

If your Internet connection is through an Ethernet cable from the wall instead of through a DSL / Cable / Satellite modem, connect the Ethernet cable directly to the router's Internet port, then follow steps 4 and 5 to complete the hardware connection.

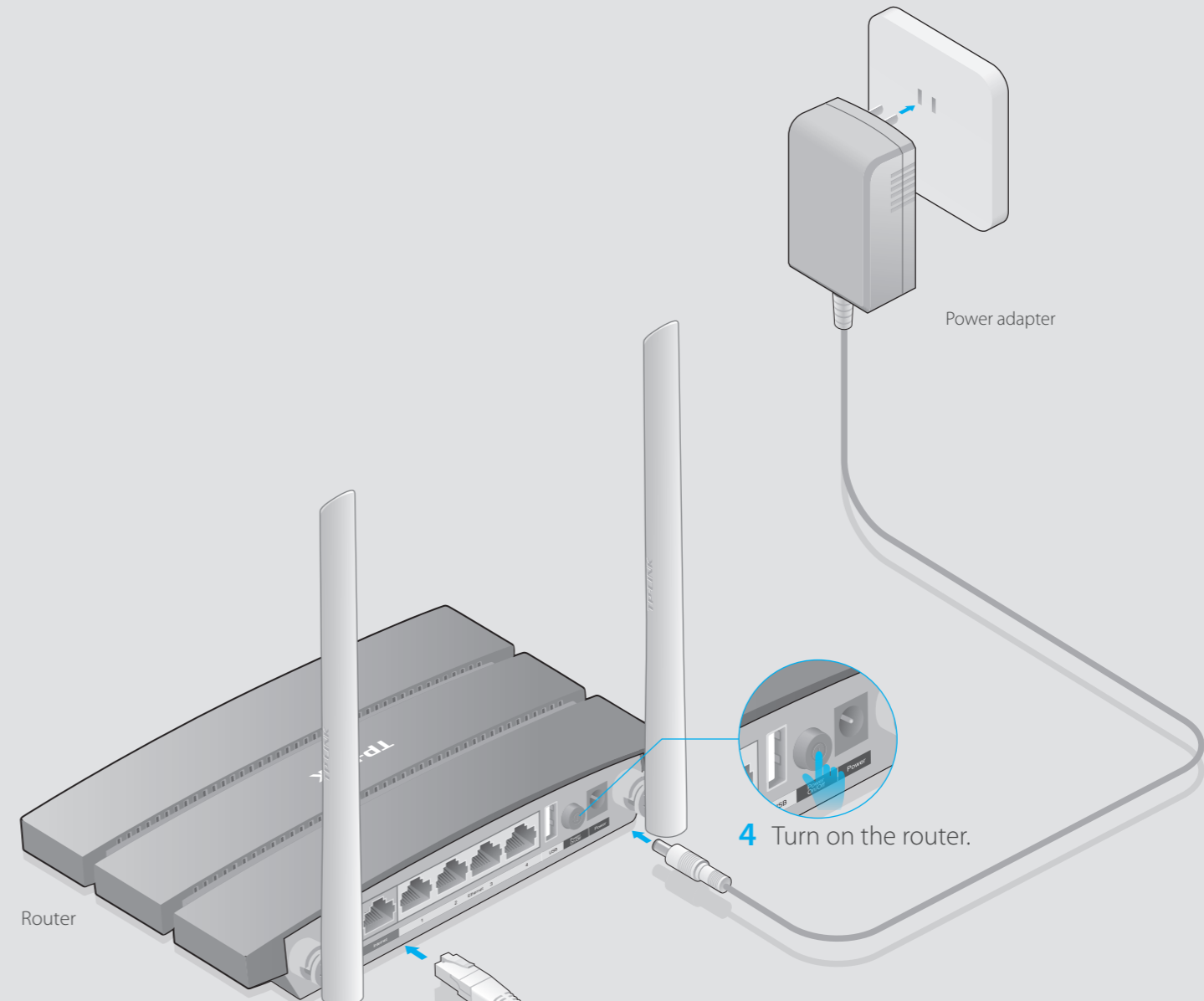

Router

Power adapter

4 Turn on the router.

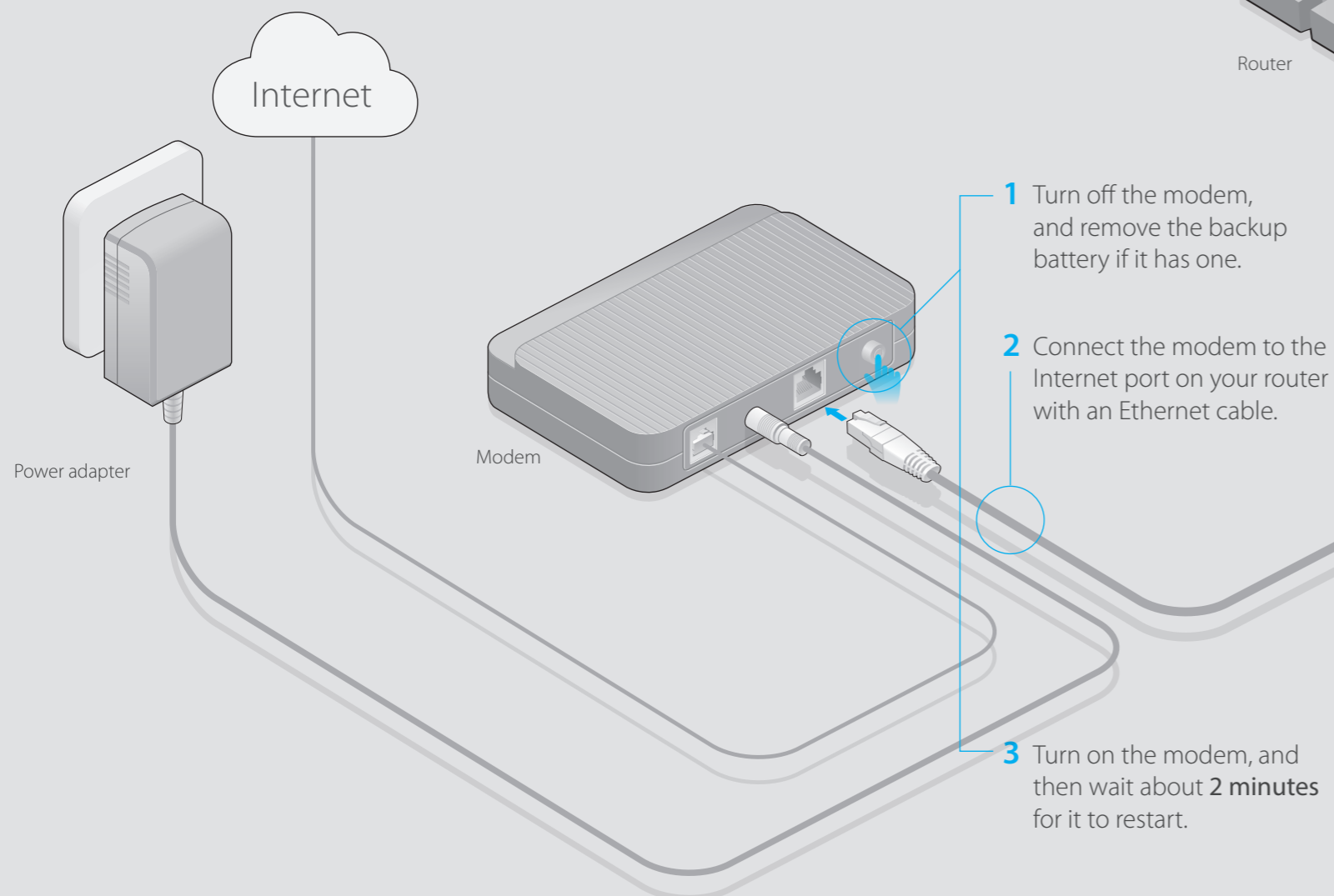

1 Turn off the modem, and remove the backup battery if it has one.

2 Connect the modem to the Internet port on your router with an Ethernet cable.

3 Turn on the modem, and then wait about 2 minutes for it to restart.

5 Verify that the hardware connection is correct by checking these LEDs.



Note: If the 2.4G LED and 5G LED are off, please press the Wi-Fi button on the rear panel for 2 seconds, then check the LEDs again in a few seconds.

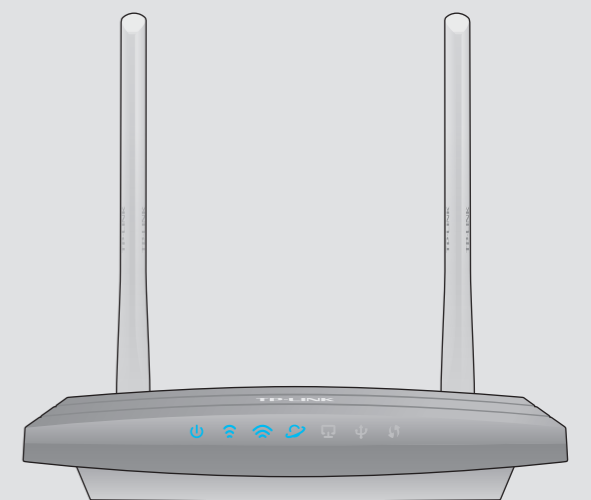

# Configure the Router

## 1. Connect your computer to the router (Wired or Wireless)

### Wired

Turn off the Wi-Fi on your computer and connect the devices as shown below.

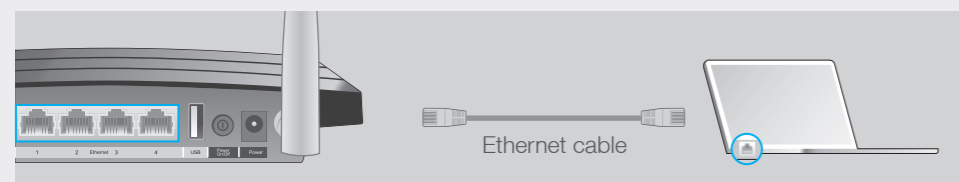

### Wireless

Connect wirelessly by using the SSID (network name) and Wireless Password printed on the product label at the bottom of the router.

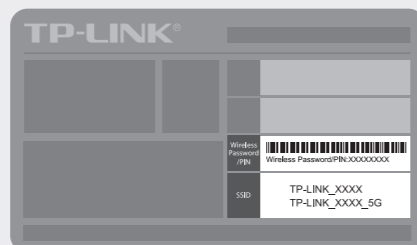

## 2. Configure the router using a web browser

**A** Enter <http://tplinkwifi.net> or <http://192.168.0.1> in the address bar of a web browser. Use **admin** for both username and password, and then click **Login**.

Note: If the login window does not appear, please refer to FAQ > Q1.

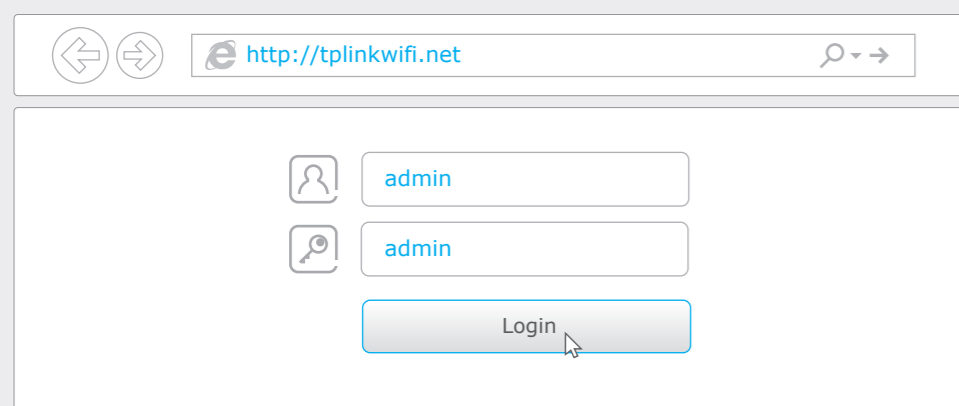

**B** Set up a new username and password, then click **Confirm**. Re-login using the new credentials.

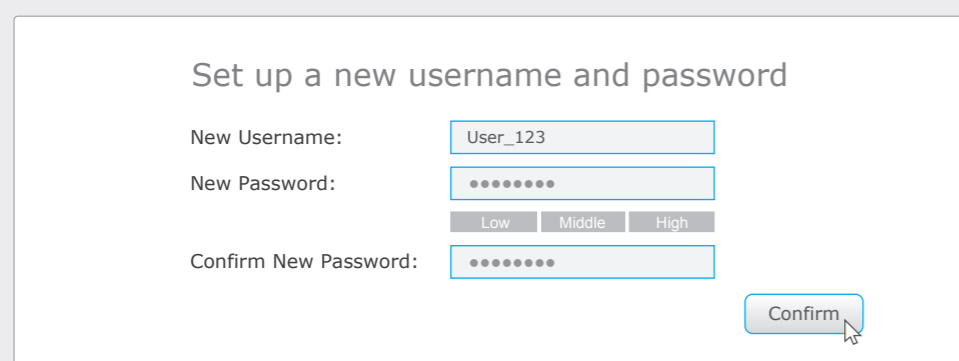

**C** Select your time zone, and click **Next**.

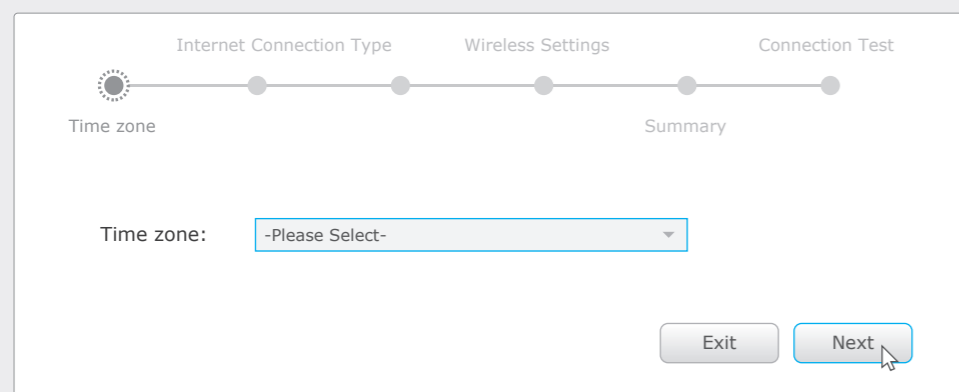

**D** Select your **Internet Connection Type**, or click **Auto Detect** if you are unsure of what your connection type is. Click **Next** and follow the instructions.

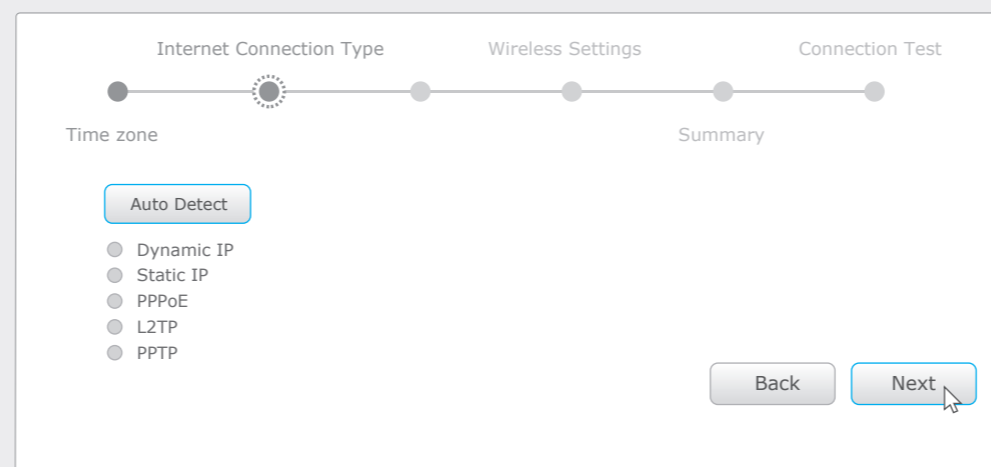

**E** Use the default or change the wireless settings, and click **Next**.

Note: If you change the default SSID and password, write down the new wireless settings.

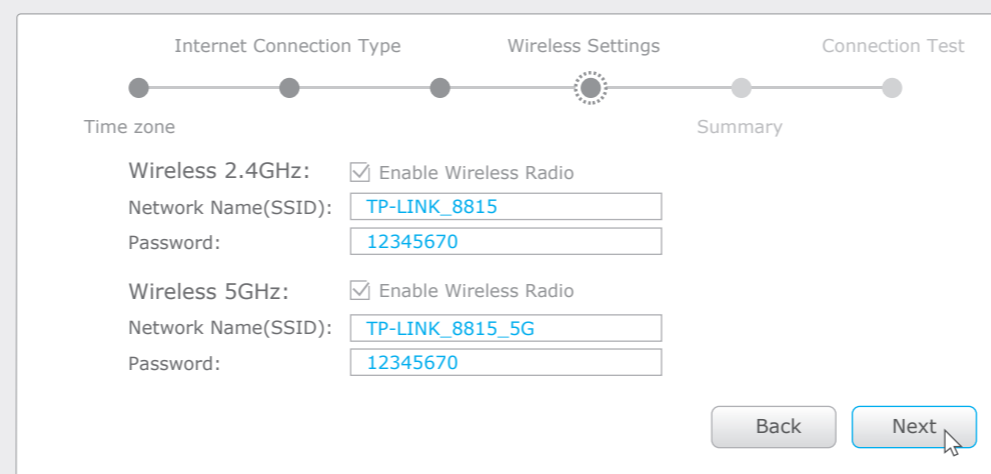

**F** Confirm your settings, and then click **Save**.

Note: For wireless devices, you may have to reconnect to the wireless network if you have changed the default Network Name or Password in Step E.

**G** Test your Internet connection, then click **Finish** to quit the Quick Setup.

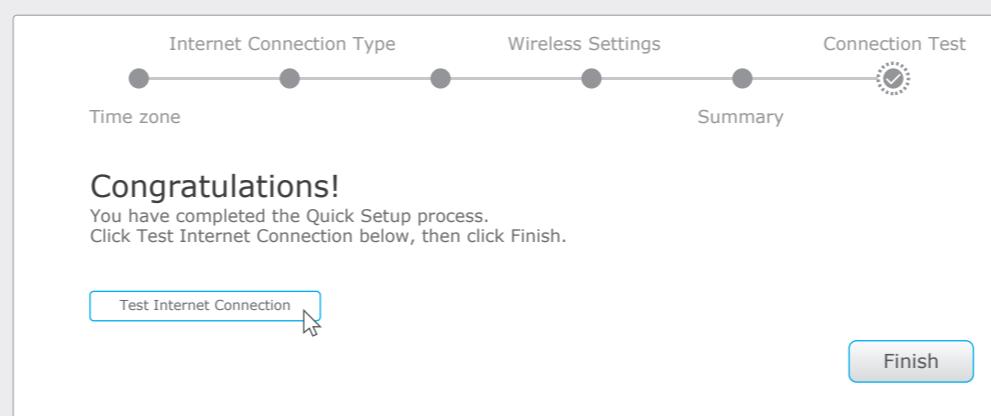

## Tether App



To conveniently manage your network, scan the QR code to download the Tether app on your mobile device.

## USB Features

Use the USB port for media sharing, storage sharing and printer sharing across your local network. You can also setup an FTP server to access your files remotely through the Internet.

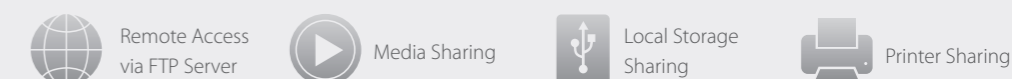
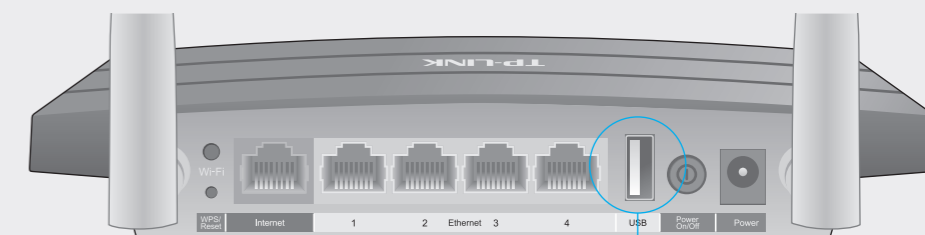

To learn more about the USB features, visit <http://www.tplink.com/app/usb>, or simply scan the QR code.



## FAQ (Frequently Asked Questions)

### Q1. What can I do if the login page does not appear?

- A1. If the computer is set to a static or fixed IP address, change the setting to obtain an IP address automatically.
- A2. Verify that <http://tplinkwifi.net> is correctly entered in the web browser. Alternatively, enter <http://192.168.0.1> or <http://192.168.1.1> in the web browser and press **Enter**.
- A3. Use another web browser and try again.
- A4. Reboot your router and try again.
- A5. Disable then re-enable the network adapter being used.

### Q2. What can I do if I cannot access the Internet?

- A1. Check if the Internet is working properly by connecting a computer directly to the modem using an Ethernet cable. If it is not, contact your Internet Service Provider.
- A2. Log in to the Web Management page of the router, and go to the **Basic > Network Map** page to check whether the Internet IP address is valid or not. If it is, please run the Quick Setup again; otherwise, recheck the hardware connection.
- A3. For cable modem users, log in to the Web Management page of the router. Go to **Advanced > Network > Internet > MAC Clone**, click **Use Current Computer MAC Address** and click **Save**, then reboot both the modem and the router.
- A4. Reboot your router and try again.

### Q3. How do I restore the router to its factory default settings?

- A1. While the router is powered on, press and hold the **WPS/Reset** button on the back until the Power LED starts blinking.
- A2. Log in to the Web Management page of the router. Go to **Advanced > System tools > Backup & Restore**, and click **Factory Restore**. The router will restore and reboot automatically.

### Q4. What can I do if I forgot my web management password?

- A. Refer to FAQ > Q3 to reset the router, and then use the default **admin** (all lowercase) for both username and password to log in.

### Q5. What can I do if I forgot my wireless network password?

- A1. The factory default Wireless Password/PIN is printed on the product label of the router.
- A2. Log in to the router's Web Management page, and go to **Basic > Wireless** to obtain or reset your wireless password.