

Wall Mounting

- Place the paper drill guide where you want the camera. Check the alignment using a level.
- Using a(n) 0.24 inch (6mm) drill bit, drill holes through the two circles on the guide. Remove the paper.
- Insert the two anchors into the holes. Place the camera mount over the anchor and use the screws to secure it
- Attach the camera.

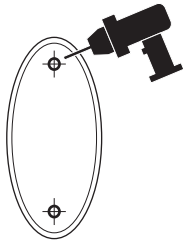

2 Mount Base

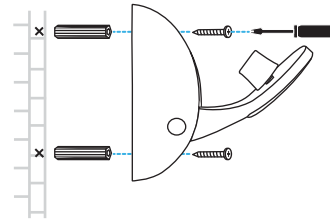

3 Secure Camera

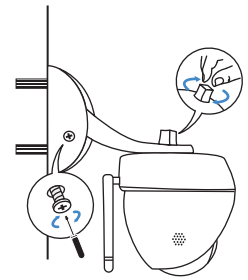

Ceiling Mounting

- Place the paper drill guide where you want the camera*
- *Camera placement can affect viewing angle. For best results, place the camera near a wall or corner.
- Using a(n) 0.24 inch (6mm) drill bit, drill holes through the two circles on the guide. Remove the paper.
 - Attach the camera mount using the screws, washers, and wingnuts.
 - Attach the camera.

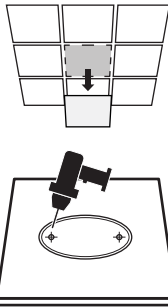

2 Mount Base

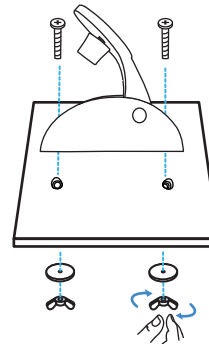

3 Secure Camera

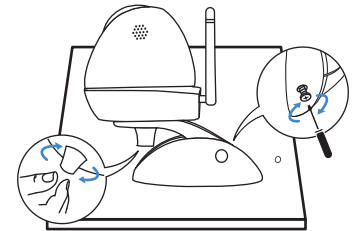

TP-LINK®

Quick Install Guide

Step One – Connect

Connect the camera and your smartphone to the same router.

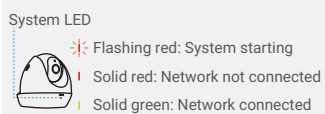
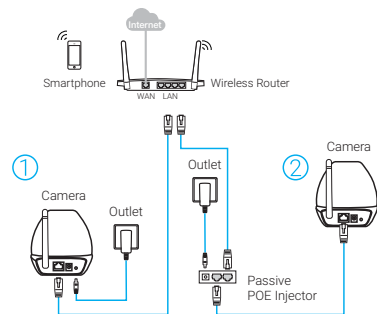

Step Two – Register

Download the tpCamera app. Once installed, open it and follow the instructions to add the camera to your TP-LINK Cloud account.



Step Three – Relocate

Place the camera where you want it. You can place it on a flat surface, or mount it as shown on the mounting section of this guide.

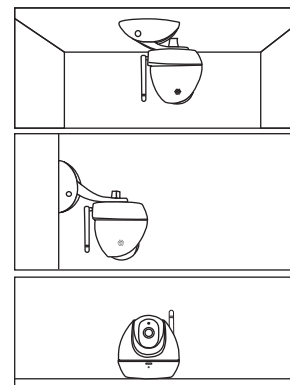

View and Enjoy

View live video using the tpCamera app or TP-LINK Cloud website.

Via tpCamera: On the "My Cam" screen, tap your camera to view video. Change the camera angle using the pan and tilt controls.

Via TP-LINK Cloud website: Log in at <https://www.tplinkcloud.com> and select your camera to view live video.

Get More

More functions with tpCamera

- Get notifications when motion is detected, and view alerts history.
- Stay in touch with 2-way audio.

View all of your cameras on one screen by downloading the TP-LINK Camera Control utility. See the Camera Control User Guide for more details. Or visit us online at www.tp-link.com for Camera Control utility, Firmware, and other support.

The WPS/Reset Button

WPS (Wi-Fi Protected Setup): If your Wi-Fi router supports WPS, you can connect the camera to your Wi-Fi network using WPS. For details, see the camera's User Guide.

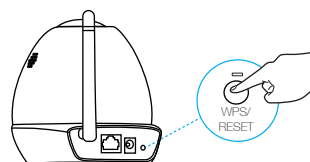

Short Press to trigger WPS and Press and hold for 5 seconds to trigger Reset.

Mounting Kit

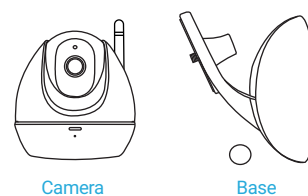

EAC

©2016 TP-LINK

