

Quick Installation Guide

300Mbps Wireless N USB VDSL/ADSL Modem Router
TD-W9970/TD-W9970B

*TD-W9970 is used for demonstration in this QIG.



1. Connecting the Hardware

1 Connect the splitter and power adapter as follows. Press the ON/OFF button and the Power LED turns on.

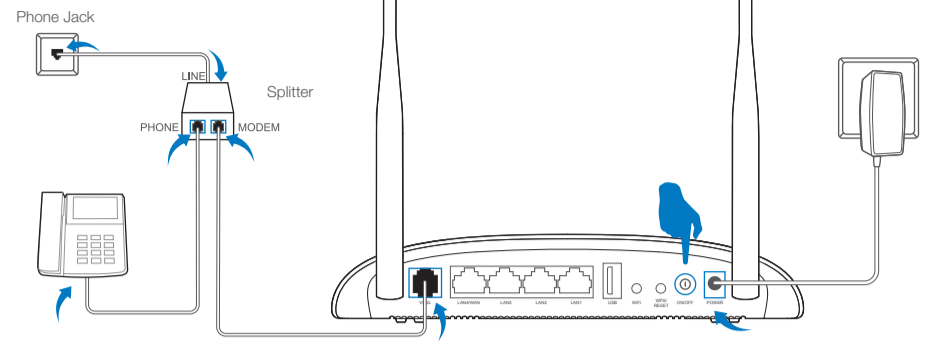

Note: If you don't need the phone service, just directly connect the VDSL port to the Phone Jack with a phone cable.

2 Check the Power and DSL LED lights to ensure the hardware connection is correct.

Notes:
Please wait 1-2 minutes until the DSL LED is on.
If the Wireless LED is off, please press the WiFi button on the rear panel for 2 seconds, then check the LEDs again in a few seconds.



2. Configuring the Modem Router

Option 1 Via Web Browser

1 Connect your computer to the modem router (Wired or Wireless).

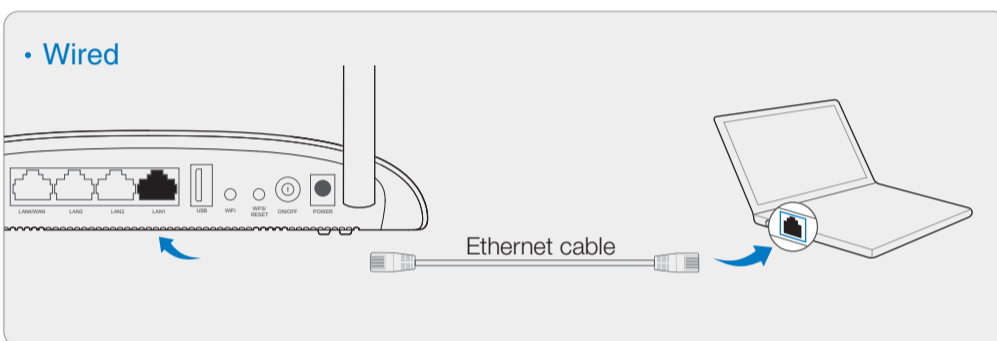

Or

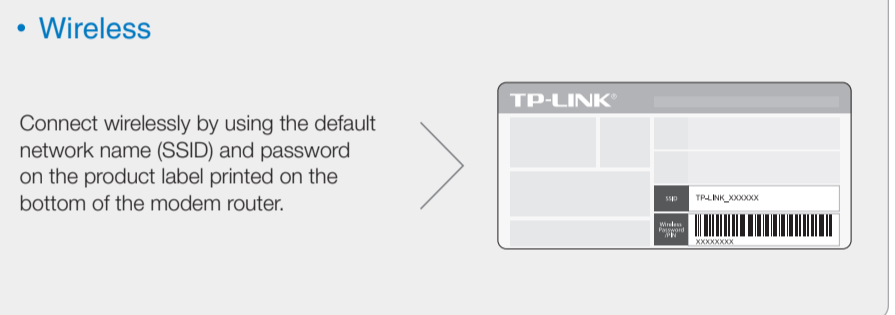

2 Open a web browser on the computer and configure the modem router according to the following main clues.

a Enter **http://tplinkmodem.net** or **http://192.168.1.1** in the address bar. Type in **admin** for both the username and password and click **Login**.

Note: If the login window does not appear, please refer to FAQ->Q1.

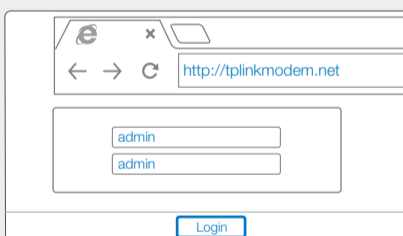

b Choose **Quick Setup** in the main menu and then click **Next** to start the configuration. Select your **Region** and **Time Zone** from the drop-down list, and then click **Next**.

Note: Per FCC regulations, all Wi-Fi products marketed in the U.S. must be fixed to the U.S. region only.

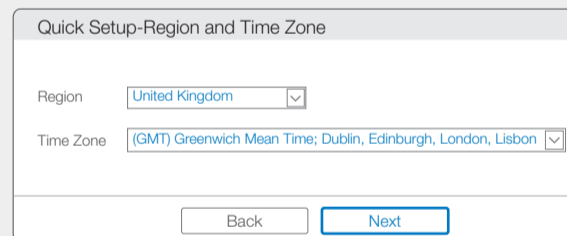

c Select **Yes** to auto detect your connection type and then click **Next** to continue.

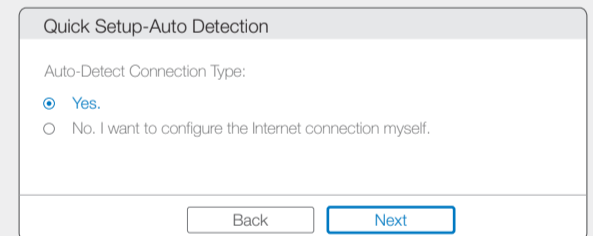

d Enter the parameters provided by your ISP and then click **Next**. Here we take **PPPoE** as an example.

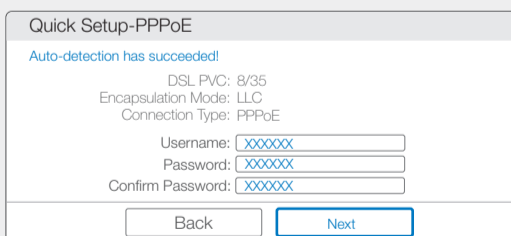

e Click **Next** to continue.

Note: You may enable 3G/4G as a backup method for Internet access.

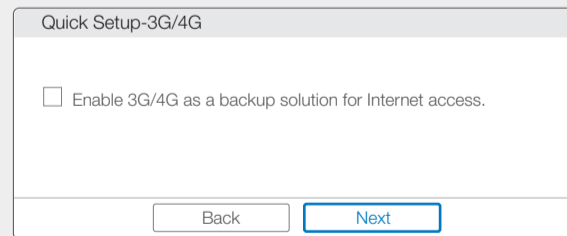

f Click **Next** to continue.

Note: You may rename your wireless network name and create your own password.

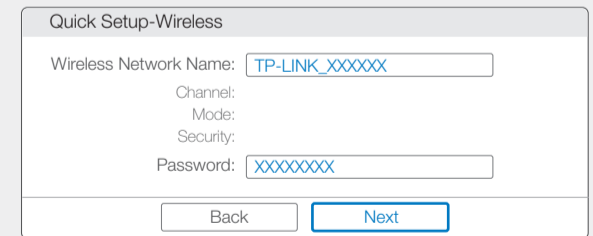

g Click **Save** and wait for your settings to take effect. Click **Finish** to complete the setup.

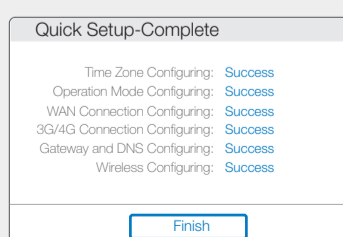

Now your wired and wireless devices can connect to the Internet!

Note: If you have changed your wireless network name and password, you must sign in with the new names/passwords to regain access to the Internet.

Option 2 Via CD Setup Wizard (For Windows users only)

Note: Mac OS X and Linux users, please follow Option 1 to configure the modem router.

- 1 Insert the TP-LINK Resource CD into the CD-ROM drive.

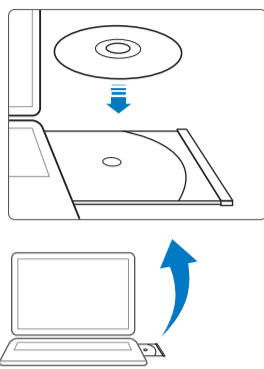

- 2 Choose your language and select TD-W9970. Then click **Start Setup**. The Easy Setup Assistant will guide you through the setup process.

Note: If the main page does not display on your computer, browse the files on the CD and double click Autorun.exe.

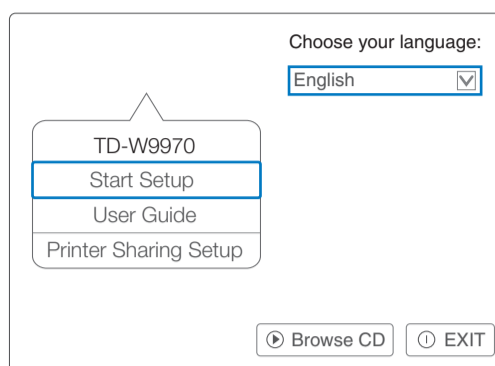

- 3 Click **FINISH** to complete the setup.

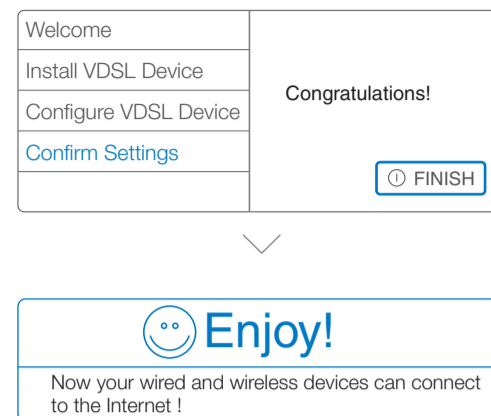

USB Features

The USB port can be used for media sharing, storage sharing and printer sharing across your local network. You can also set up the FTP server to access your files remotely by connecting to the Internet.

Note: To learn more about the USB features, please visit <http://tp-link.com/app/usb>, retrieve Resource CD or simply scan the QR code.

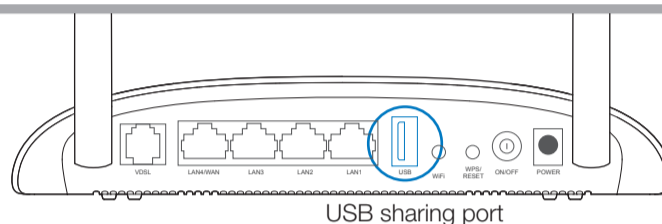

Frequently Asked Questions (FAQ)

Q1. What can I do if the login window does not appear?

- A1. If the computer is set to a static or fixed IP address, change it to obtain an IP address automatically.
- A2. Verify <http://tplinkmodem.net> or <http://192.168.1.1> is correctly entered in the web browser and press Enter.
- A3. Use another web browser and try again.
- A4. Reboot your modem router and try again.
- A5. Disable the network adapter used currently then enable it again.

Q2. What can I do if I cannot access the Internet?

- A1. Check your cables and make sure they are all plugged in correctly, including the telephone line, Ethernet cable and power adapter.
- A2. Check to see if you can log on to the Web-Management page of the modem router. The default address of the Web-Management page is <http://tplinkmodem.net> or <http://192.168.1.1>. If you can, try the following steps. (If you can not, please set your computer to obtain an IP address automatically and then try to access the Internet again.)
- A3. Consult your ISP and make sure all the VPI/VCI, Connection Type, account username and password are correct. If they are not, please replace them with the correct settings and try again.
- A4. If you still cannot access the Internet, please restore your modem router to its factory default settings and reconfigure your modem router following the instructions in this QIG.
- A5. Please contact our Technical Support if the problem still exists.

Q3. How do I restore the modem router to its factory default settings?

- A1. With the modem router powered on, press and hold down the WPS/RESET Button on the rear panel of the modem router for approximately 5 seconds.
- A2. Log in Web Management page of the modem router, and go to System Tools->Factory Defaults, click Restore, then wait until the progress bar loading finished.

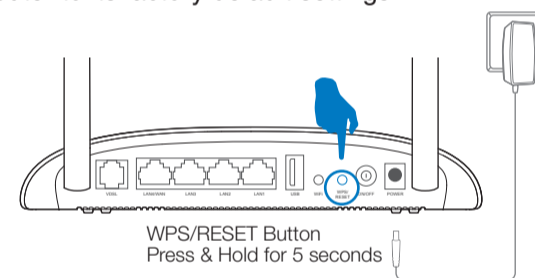

Q4. What can I do if I forget my password?

- **Web Management page password:**
Restore the modem router to its factory default settings and then use the default Username 'admin' and Password 'admin' to log in.
- **Wireless Network password:**
A1. The factory default password can be found on the product label printed on the bottom of the modem router.
A2. If you have changed your password, log on to the modem router's Web Management page, go to Wireless->Wireless Security to obtain or reset your password.

LED Indicators

Name	Status	Indication
(Power)	On Flash Off	System start-up complete. System starting up or device updating. Power is off.
(DSL)	On Flash Off	DSL line is synchronized and ready to use. The DSL negotiation is in progress. There is no connection to the DSL Port or DSL synchronization fails.
(Internet)	On Off	The network is available with a successful Internet connection. There is no successful Internet connection or the modem router is operating in Bridge mode.
(Wireless)	On Off	The wireless function is working properly. The wireless function is disabled.
(WPS)	On/Off Flash	It turns on when a wireless device has been successfully connected to the network via WPS. After about 5 minutes, the WPS LED will turn off. WPS handshaking is in process and will continue for about 2 minutes.
(USB)	On Flash Off	The USB device is identified and ready to use. The USB device is being identified. No USB device is plugged in to the USB port.
(LAN 1-4)	On Off	There is a device connected to this LAN Port. There is no device connected to this LAN Port.