

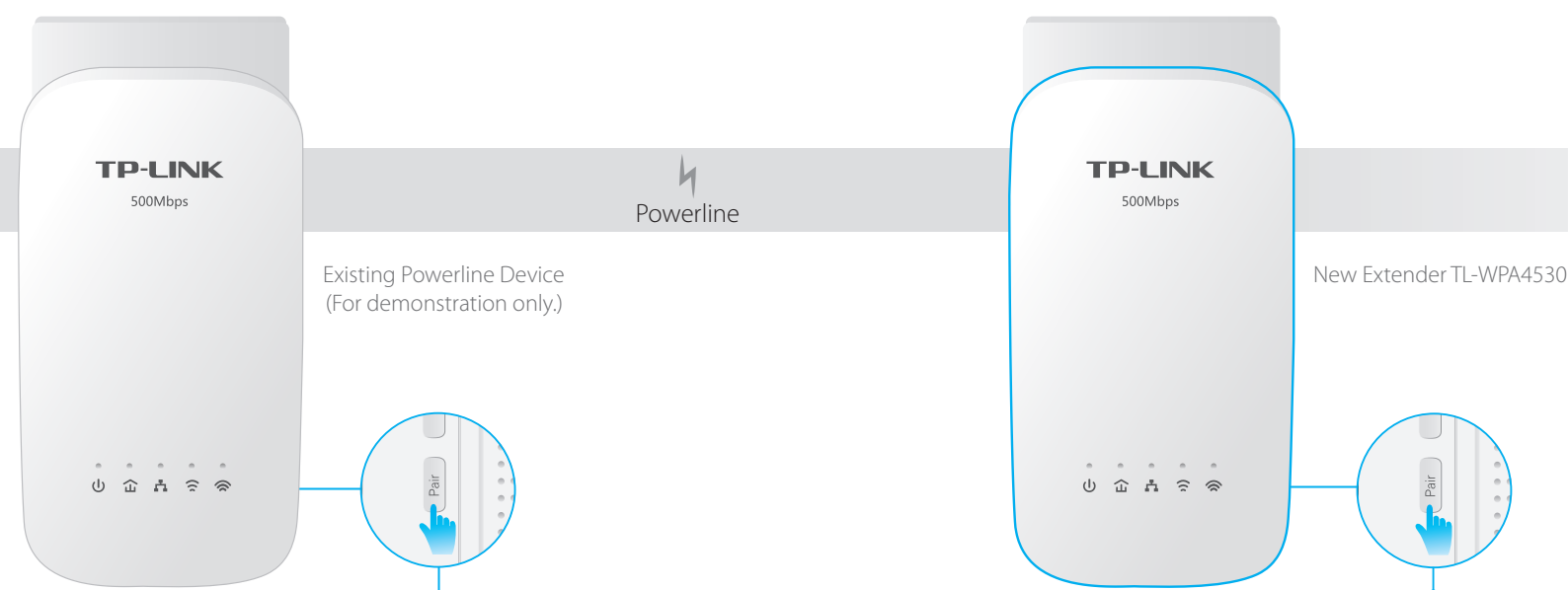

Hello, I'm here.
Follow me to extend your Wi-Fi network.

1 Plug in the new extender in the same room with one of your existing powerline devices.



2 Check the new extender's Powerline LED , is it on?

- YES
Proceed to Step [4](#).
- No
Continue with the steps below.



3 A. Press the Pair button on the existing powerline device for 1 second. The Power LED  starts blinking.

* If  does not blink, press the button again.

B. Press the Pair button on the new extender for 1 second. The Power LED  starts blinking. When the Powerline LED  is on and stable, the pairing process is complete.

4 Relocate the new extender to the Wi-Fi "dead" zone. Use the SSID and password on the provided Wi-Fi Info Card to connect to the Internet.

* A red Powerline LED  indicates poor signal strength, move the extender to another location.

If you cannot find the SSID on the Info card in your Wi-Fi network list, which means the existing wireless settings have synced to your new extender via the Wi-Fi Auto-Sync feature (see back for more info), use the same SSID and password of the existing powerline network to connect.



 Enjoy!

Tips: Please plug your powerline devices into wall outlets on the same electrical circuit.

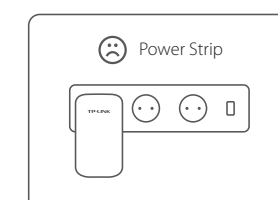
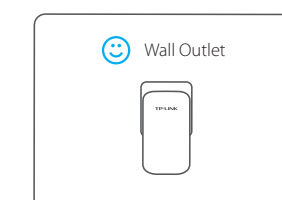

Wi-Fi Clone

Wi-Fi Clone allows you to copy the main router's wireless settings (SSID and password) to the powerline extender in seconds.

1. Plug in the powerline extender near your router, and press the WPS button on the router.
2. Within 2 minutes, press the Wi-Fi button on the extender for 1 second.

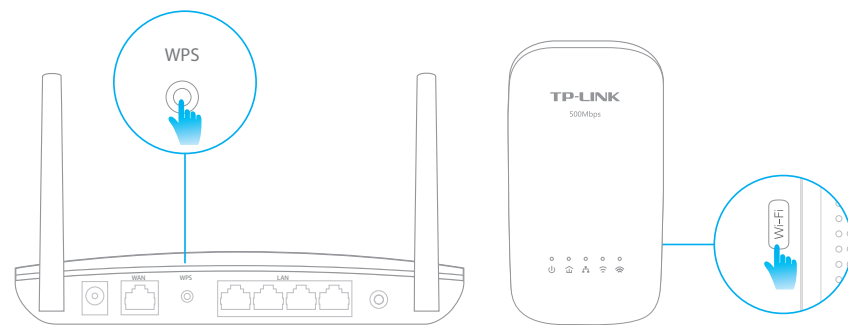

3. When the 2.4GHz Wi-Fi LED and 5GHz Wi-Fi LED on the extender blink quickly for 3 seconds and then stay on, use the router's SSID and password to join the Wi-Fi network.

* By default, both 2.4GHz and 5GHz wireless settings will be copied at the same time. If not, your router may be only able to clone one band at a time. Please refer to your router's manual for instructions.

Wi-Fi Auto-Sync

Wi-Fi Move technology helps to keep the wireless settings on your powerline extenders in sync.

The wireless settings automatically sync from one powerline extender to another when pairing a new device to the secure powerline network.

Any changes that you make to one powerline extender will automatically apply to all powerline extenders in your secure powerline network.

* This feature is enabled by default and can be accessed via the extender's web interface.

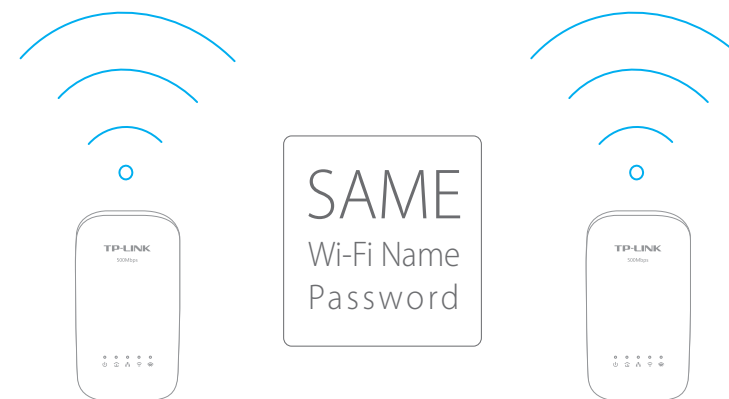

Button Legend

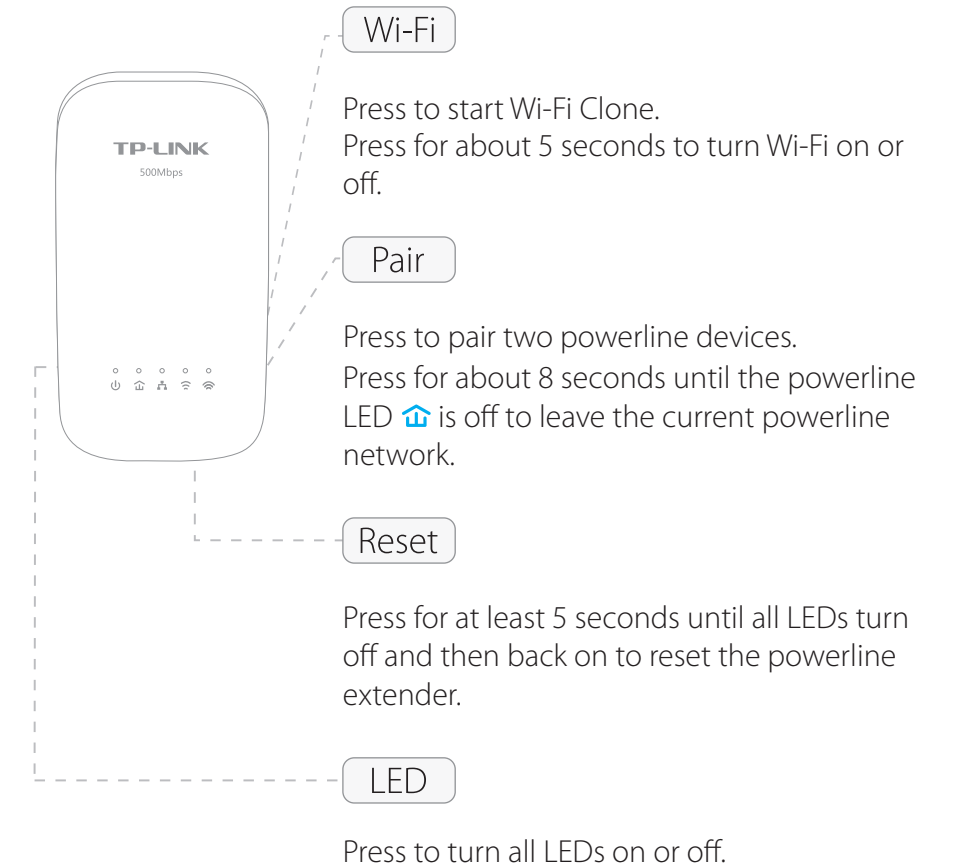

Easy Management

Using tpPLC utility and app for basic configuration:

Download the tpPLC Utility (for Windows only) at <http://www.tp-link.com>.

Download the tpPLC App from the App Store or Google Play, or simply scan the QR code.



Using web interface for advanced configuration:

Connect your device to the powerline extender wirelessly and visit <http://tplinkplc.net>. Use 'admin' for both username and password on initial login.

Frequently Asked Questions

Q1. How to reset my powerline extender?

A. With the extender plugged in, use a pin to press and hold the Reset button until all LEDs turn off. When the LEDs turn back on, the reset process is complete.

Q2. What can I do if there is no Internet connection in my powerline network?

- A1. Make sure all powerline adapters and extenders are on the same electrical circuit.
- A2. Make sure each device's Powerline LED is on. If not, pair your devices again.
- A3. Make sure all hardware connections are correctly and securely connected.
- A4. Check if you have an Internet connection by connecting the computer directly to the modem or router.

Q3. What can I do if a successfully-paired extender does not reconnect after relocating?

- A1. Make sure all powerline adapters and extenders are on the same electrical circuit.
- A2. Pair it again with another powerline device, and make sure the Powerline LED is on before relocating it.
- A3. Check for possible interference, such as washers, air conditioners or other household appliances that may be too close to one of the powerline devices.