

Hello, Touch P5

Start Here >>

Before You Start

If your Internet connection is through an Ethernet cable from the wall, instead of through a modem, connect the Ethernet cable directly to the router's Internet port, and skip step 2,3,4.

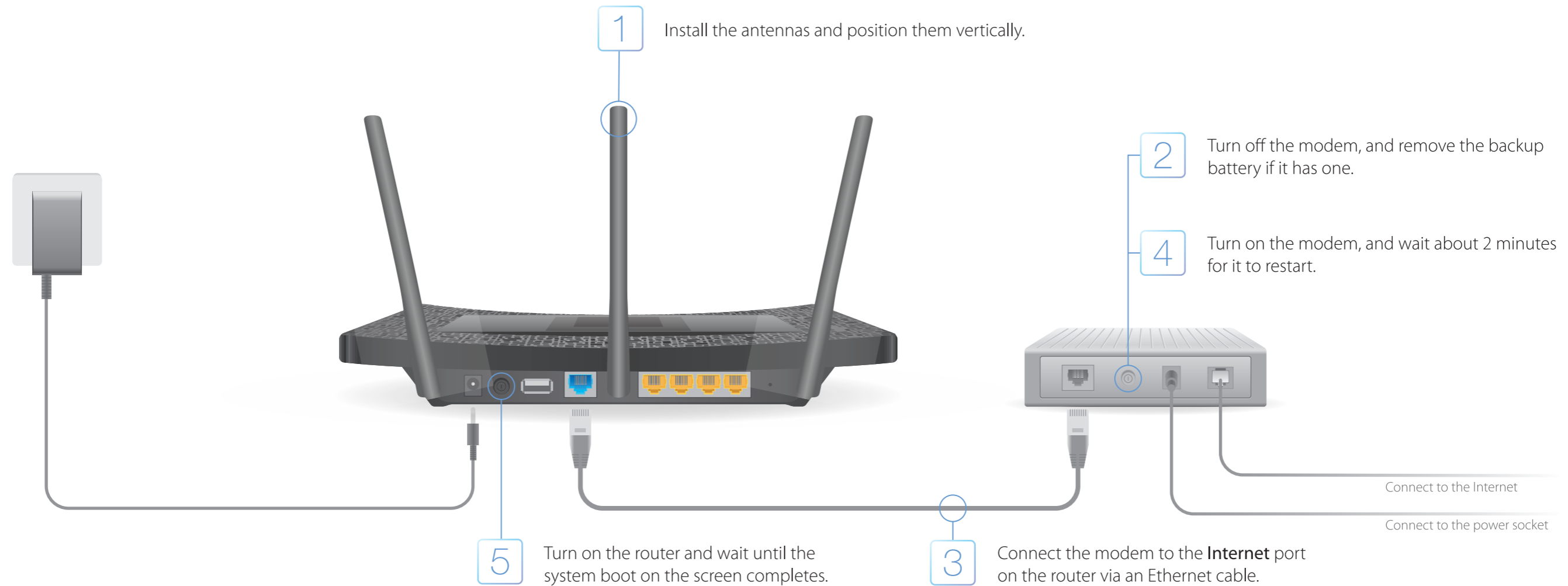

6 Configure the router on the touchscreen display.

Create a new administrator password (recommended) and tap **Save**, then follow the Quick Setup to complete the initial configuration.

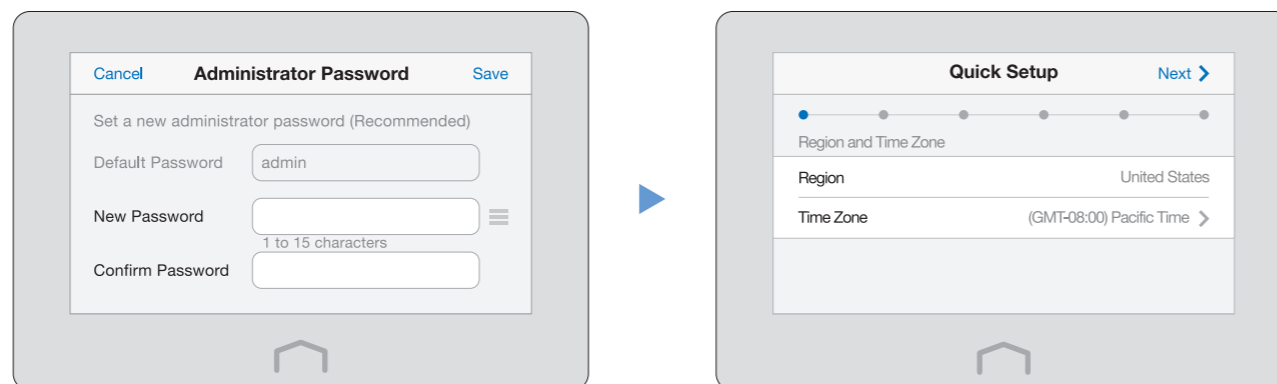

Note: Per FCC regulations, all Wi-Fi products marketed in the U.S. is fixed to the U.S. region.

Enjoy!

Connect your devices to the router wirelessly or via an Ethernet cable.



Note: If you have not changed the SSID and password during the configuration, use the default SSID and password printed on the bottom of the router to join the wireless network.

Touchscreen Display

The screen will go to sleep if it idles for 3 minutes by default. Tap the screen to wake it up.

Home Screen

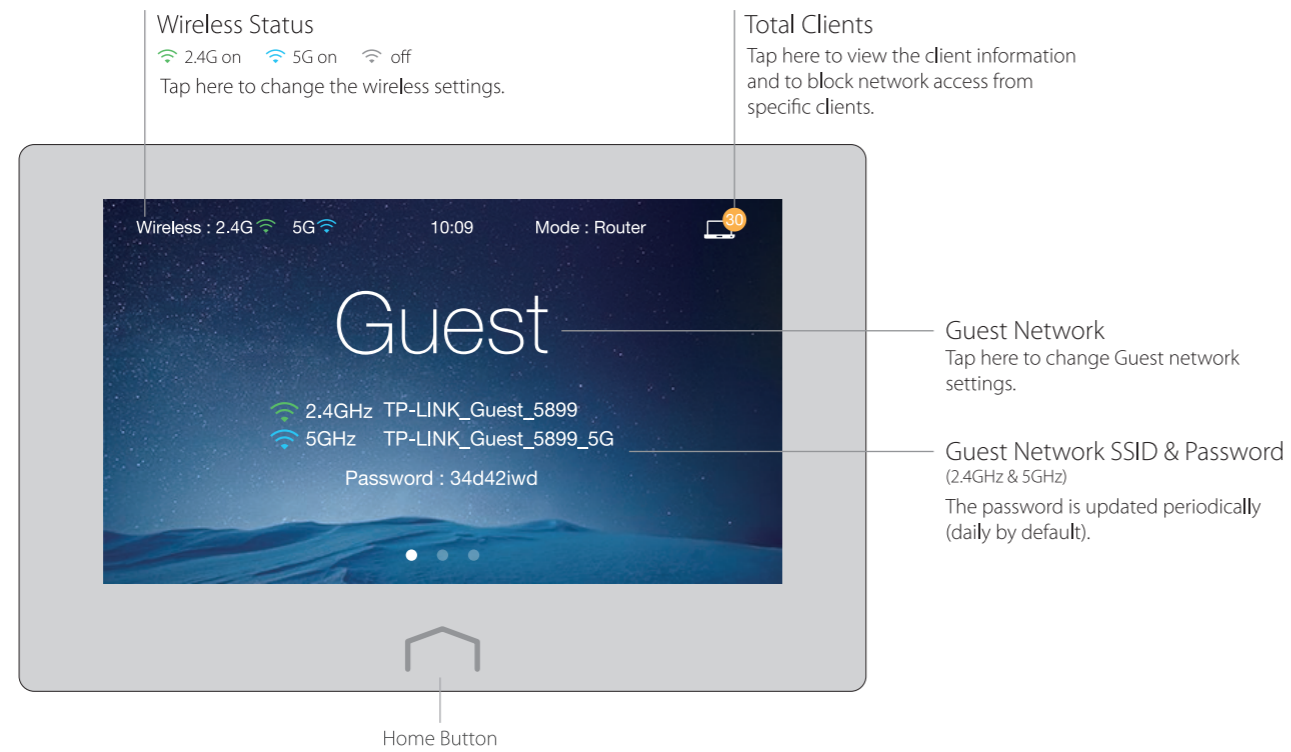

Menu Screen

Tap the icons to perform various functions of the router, such as Quick Setup, Mode Selection, Parental Controls, etc.

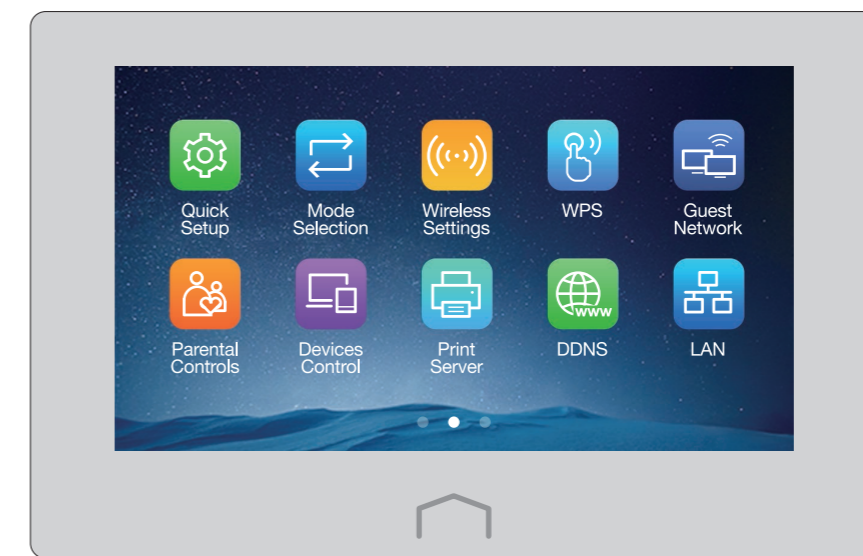

Note: You also can manage the router through the web-based management interface at <http://tplinkwifi.net> (Enter **admin** for the username and your administrator password to log in.)

USB Features

Use the USB ports for media sharing, storage sharing and printer sharing across your local network. You can also set up an FTP server to access your files remotely through the Internet.



FAQ (Frequently Asked Questions)

Q1. What can I do if I cannot access the Internet?

- A1. Check if the Internet is working properly by connecting a computer directly to the modem via an Ethernet cable. If not, contact your Internet Service Provider.
- A2. Tap **Quick Setup** on the menu screen to run the setup again.
- A3. Tap **Reboot & Reset** on the menu screen, select **Reboot** to reboot the router and try again.
- A4. If your Internet Connection Type is **Dynamic IP**, go through **Quick Setup** and enter the MAC address that is registered with your ISP, then reboot both the modem and the router.

Q2. What can I do if I forgot my administrator password?

- A. While the router is powered on, press and hold the **Reset** button on the back until the Touch P5 logo displays to restore the router to its factory default settings, and create a new administrator password.

Q3. What can I do if I forgot my wireless network password?

- A1. Tap **Wireless Settings** on the menu screen to obtain the security password, both for 2.4GHz and 5GHz wireless network.
- A2. For the Guest network, the password displays on the home screen.

Q4. How do I restore the router to its factory default settings?

- A1. Tap **Reboot & Reset** on the menu screen, and then tap **Reset**.
- A2. While the router is powered on, press and hold the **Reset** button on the back until the Touch P5 logo displays.