

# Quick Installation Guide

Applicable Model:

**RE200** **EAC**

**WPS** Method ONE: Quick Setup using the WPS Button

**E** Method TWO: Setup using your Web Browser



7106505279 REV1.0.1

## LED Explanation

### 5G/2.4G

**Solid Green:** The Range Extender is connected to the 5G/2.4G wireless network of your main Router/AP, and the **signal strength is strong.**  
**Solid Red:** The Range Extender is connected to the 5G/2.4G wireless network of your main Router/AP, but the **signal strength is weak.**  
**Off:** The Range Extender isn't connected to your main Router/AP.

### Wi-Fi (Wireless Signal)

**On:** The Range Extender's wireless function is enabled.  
**Off:** The Range Extender's wireless function is disabled.

### (ETHERNET)

**On:** A device is connected to the ETHERNET port, but there is no activity.  
**Flashing:** A device is connected to the ETHERNET port, and is active.  
**Off:** No device is connected to the ETHERNET port.

### (Power)

**On:** The Range Extender is on.  
**Off:** The Range Extender is off.

### (RE)

**On:** The Range Extender has established a secure connection.  
**Flashing:** The Range Extender is establishing a secure connection.  
**Off:** No active connection.

## Method ONE Quick Setup using the WPS Button

Use this if your Router or Access Point(AP) supports WPS

### 1 Power on

Plug your Range Extender into a power outlet near your Router/AP.

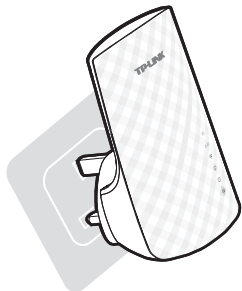

⌚ Wait until the 'Power' and 'Wi-Fi' LEDs light up.

### 2 Push the two WPS buttons

- 1 Push the WPS button on your Router/AP.
- 2 Immediately push the button on your Range Extender.

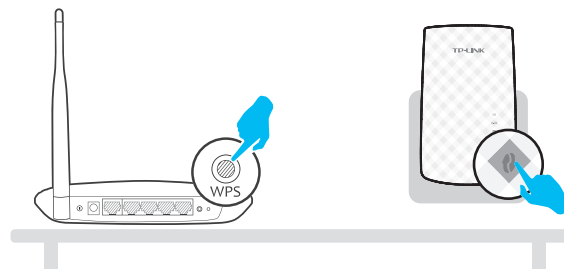

⚠ If the WPS connection fails, please go to Method TWO.

⌚ The 'RE' LED should go from flashing to solid, showing that WPS connection has succeeded, then it will turn off in 2 minutes.

### 3 Relocate

After you have configured your Range Extender, move it to a location for the best signal quality and coverage in your house. The Range Extender will automatically **reconnect to your main Router/AP within about 30 seconds** after you plug it into another power outlet. \* Keep the following in mind:

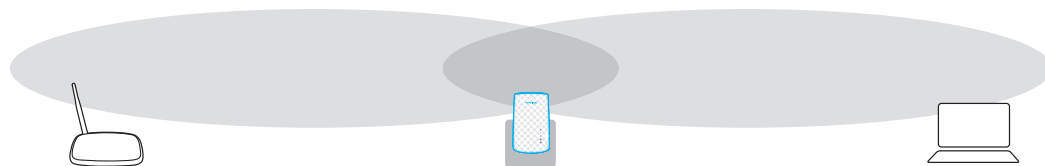

The ideal location for your Range Extender is **Halfway** between your main Router/AP and Wi-Fi-enabled devices.

If possible, try to place your Range Extender in a location where the **2.4G/5G LEDs are Green.**



Keep the Range Extender away from devices like cordless phones, Bluetooth devices and Microwave Ovens to minimize wireless interference.

If possible, try to place your extender in **open corridors or spacious locations** rather than a crowded room.

## Enjoy!

The Range Extender **shares** the same **Wi-Fi Network Name (SSID)** and **Wi-Fi Password** with your main Router/AP.

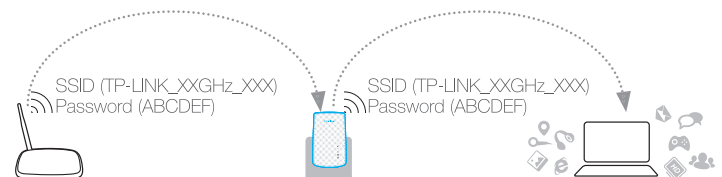

## Frequently Asked Questions (FAQ)

### Q1. How to reset the Range Extender?

A1: While the Range Extender is plugged into a power outlet, press the **RESET** button with a pen for 1 second. Wait 2 seconds until all the LEDs flash once.

OR

A2: Use your web browser to log into the management page, go to "System Tools -> Factory Defaults" and click "Restore". Wait 5 seconds until all the LEDs flash once.

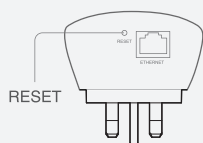

### Q2. I typed http://tplinkrepeater.net in the browser URL bar, why can't I see the quick setup page?

A: First, make sure your computer is connected to the extender network and disconnected from any other network. Second, make sure your computer is set to "Obtain an IP address automatically".

### Q3. What's the technical support hotline?

A: Please visit "www.tp-link.com", find "Support>Contact Technical Support>Hotline Support" for more information.

## Method TWO Setup using your Web Browser

### 1 Power on

Plug your Range Extender into a power outlet **near** your Router/AP.

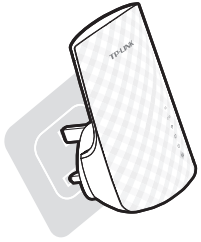

Wait until the 'Power' and 'Wi-Fi' LEDs light up.

### 2 Connect your computer to the Range Extender

Connecting via **Ethernet Cable**

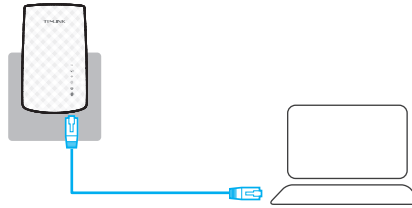

1. Disconnect your computer from all wireless networks.
2. Connect the Range Extender to your computer via an Ethernet cable. Then go to **Step 3**.

Connecting via **Wireless**



1. Disconnect your Ethernet Connection. Click the **Wireless Network Connection** icon on your desktop.

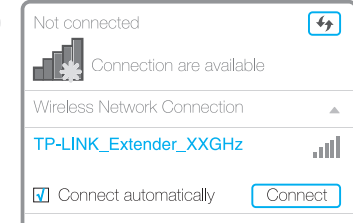

2. Click the **Refresh** icon and connect to the Range Extender (the default wireless network name is: **TP-LINK\_Extender\_XXGHz** as listed on the rear panel) and go to **Step 3**.

### 3 Configure

- 1 Type "<http://tplinkrepeater.net>" in your Web browser and press **Enter**. Log in to the management page using user name "**admin**" and password "**admin**".



It may take 5 seconds or more for the **login page** to pop up. If it does not pop up, **refresh** the browser, otherwise, please refer to the [FAQ > Q2](#).

- 2 Below are the major setup process steps.

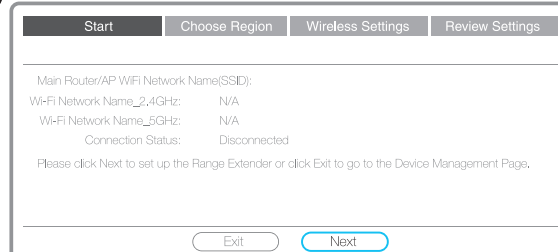

a. The **Quick Setup** page appears when you login in.

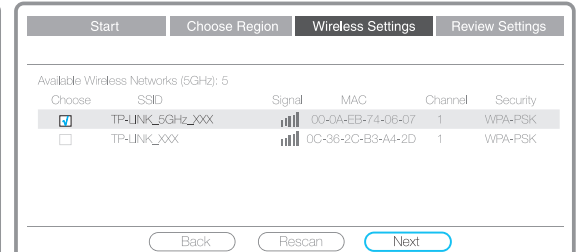

d. Select your Router/AP's **5GHz Wireless Network**, for example, **TP-LINK\_5GHz\_XXX**.

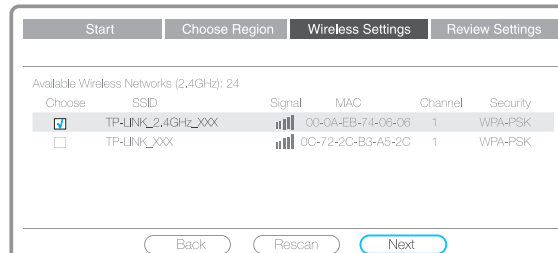

b. Select your Router/AP's **2.4GHz Wireless Network**, for example, **TP-LINK\_2.4GHz\_XXX**.

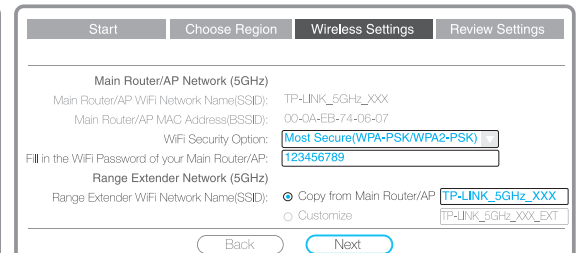

e. Fill in the **Wi-Fi Password** of your main Router/AP. You can copy the **Wi-Fi Network Name (SSID)** from your main Router/AP (**TP-LINK\_5GHz\_XXX**) or set a new one (**TP-LINK\_5GHz\_XXX\_EXT**).

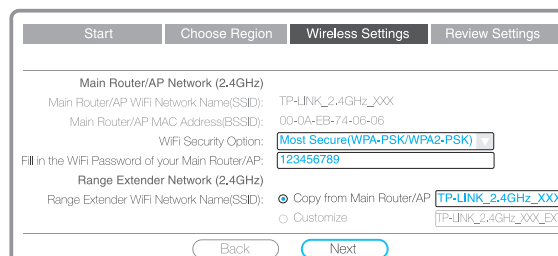

c. Fill in the **Wi-Fi Password** of your main Router/AP. You can copy the **Wi-Fi Network Name (SSID)** from your main Router/AP (**TP-LINK\_2.4GHz\_XXX**) or set a new one (**TP-LINK\_2.4GHz\_XXX\_EXT**).

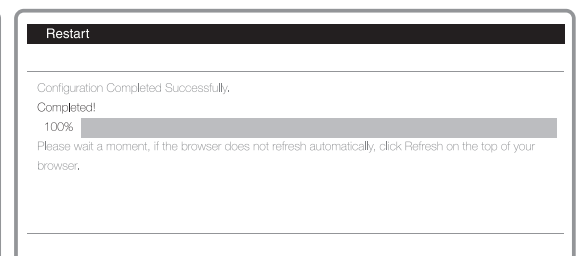

f. The **2.4G/5G LEDs** will light up if the configuration is successful.

### 4 Relocate

Refer to **Step 3** of **Method ONE** on the other side.

### Enjoy!

Choose the Range Extender's **Wi-Fi Network Name** (**TP-LINK\_XXGHz\_XXX** or **TP-LINK\_XXGHz\_XXX\_EXT**). The Range Extender **shares** your main Router/AP's **Wi-Fi Password**.

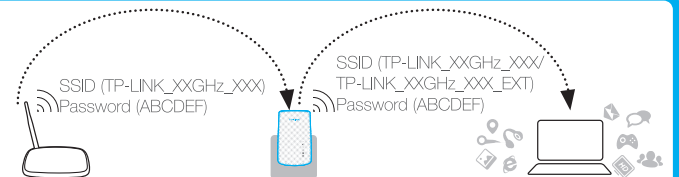

### Entertainment Adapter

The Range Extender's single **ETHERNET** port allows the Range Extender to function as a wireless adapter connecting a wired device like Blu-ray players, game consoles, DVRs and smart TVs. At the same time, the device can share the wireless network. Please follow **Method ONE** or **Method TWO** to set up the Range Extender first and then refer to this connection diagram to connect it to **one** Ethernet-enabled device.

