

# Installation Guide

SFP XGSPON&GPON Combo Class C+ Module  
SFP GPON Class C++ Module  
SFP GPON Class C+ Module

For technical support and other information, please visit  
<https://www.tp-link.com/support>, or simply scan the QR code.



\* Images may differ from actual products.

## Install the Transceiver

1. Wear an ESD-preventive wrist or ankle strap to prevent ESD damage to the transceiver.
2. Insert the transceiver into the slot and firmly press it into place.

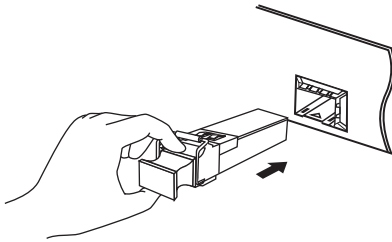

3. Remove the protective dust plug from the transceiver.

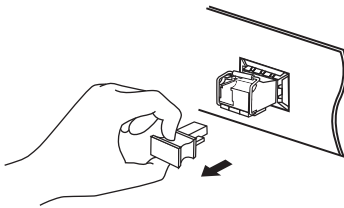

4. Plug a fiber-optic cable into the transceiver. Note that the transceiver works without any additional configuration.

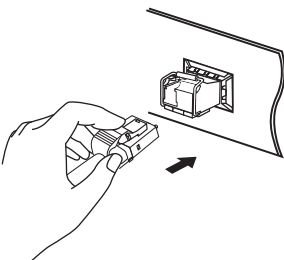

## Remove the Transceiver

1. Wear an ESD-preventive wrist or ankle strap to prevent ESD damage to the transceiver.
2. Disconnect the network fiber-optic cable from the transceiver.

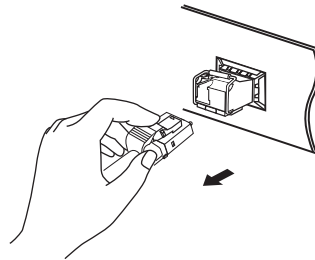

3. Pull the safety latch downwards to release the transceiver, and then pull it out from the slot.

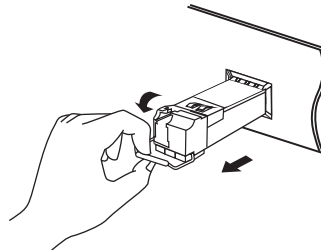

4. Reinstall the protective dust plug in the transceiver's optical bores and place it on antistatic mat or a static shielding bag.

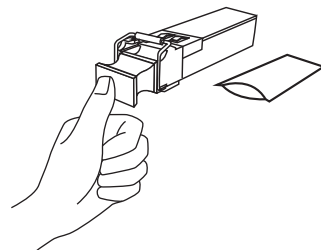

### Note:

1. Do not touch the output pins on the transceiver with your hand.
2. Always keep the protective dust plug on the transceiver's optical bores until you are ready to make a connection.

### Caution:

DO NOT point or stare directly into the beam or into the optical port of the transceiver when it is operating, as this can injure your eyesight.

## Connection

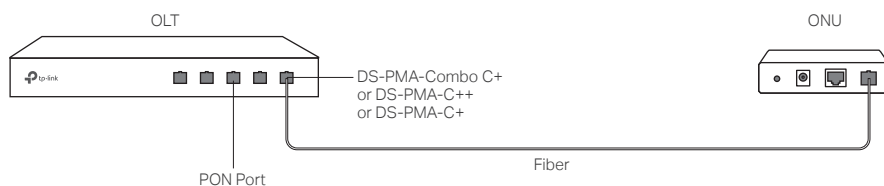

## Specifications

### General Specifications

Normal	DS-PMA-Combo C+	DS-PMA-C++	DS-PMA-C+
Wave Length	XGS-PON: Tx: 1577 nm, Rx: 1270 nm XG-PON: Tx: 1577 nm, Rx: 1270 nm GPON: Tx: 1490 nm, Rx: 1310 nm	GPON: Tx: 1490 nm, Rx: 1310 nm	GPON: Tx: 1490 nm, Rx: 1310 nm
Standards and Protocols	ITU-T G.984.2 Amendment 2	ITU-T G.984.2 Amendment 2	ITU-T G.984.2 Amendment 2
Cable	Single-mode Fiber	Single-mode Fiber	Single-mode Fiber
Fiber Type	9/125 $\mu$ m Single-mode	9/125 $\mu$ m Single-mode	9/125 $\mu$ m Single-mode
Max. Cable Length	20 km	20 km	20 km
Data Rate	XGS-PON: Tx: 9953 Mbit/s, Rx: 9953 Mbit/s XG-PON: Tx: 9953 Mbit/s, Rx: 2488 Mbit/s GPON: Tx: 2488 Mbit/s, Rx: 1244 Mbit/s	GPON: Tx: 2488 Mbit/s, Rx: 1244 Mbit/s	GPON: Tx: 2488 Mbit/s, Rx: 1244 Mbit/s
Tx Power	XGS-PON: +5 dBm ~ +8 dBm GPON: +3 dBm ~ +7 dBm	GPON: +5 dBm ~ +10 dBm	GPON: +3 dBm ~ +7 dBm
Port Type	Combo PON, SC	GPON SFP, SC/UPC	GPON SFP, SC/UPC
Power Support	3.3 V	3.3 V	3.3 V
Safety & Emission	FCC 47 CFR Part 15, Class B CE, Class B	FCC 47 CFR Part 15, Class B CE, Class B	FCC 47 CFR Part 15, Class B CE, Class B
DDM	Yes	Yes	Yes
SFP-MSA	Yes	Yes	Yes
Hot Swappable	Yes	Yes	Yes

## Safety Information

- Keep the device away from water, fire, humidity or hot environments.
- Keep the device away from fire or hot environments. DO NOT immerse in water or any other liquid.
- Do not attempt to disassemble, repair, or modify the device.
- Avoid using this product during an electrical storm. There may be a remote risk of electric shock from lightning.
- Do not point or stare directly into the beam or into the optical port of the transceiver when it is operating, as this can injure your eyesight.



## EU Declaration of Conformity

TP-Link hereby declares that the device is in compliance with the essential requirements and other relevant provisions of directives 2014/30/EU, 2014/35/EU, 2011/65/EU and (EU)2015/863.

The original EU declaration of conformity may be found at <https://www.tp-link.com/en/support/ce/>

## UKCA Declaration of Conformity

TP-Link hereby declares that the device is in compliance with the essential requirements and other relevant provisions of the Electromagnetic Compatibility Regulations 2016 and Electrical Equipment (Safety) Regulations 2016.

The original UK declaration of conformity may be found at <https://www.tp-link.com/support/ukca/>