



EasyMesh
— Compatible —

AC1900 Wi-Fi Router

Dual Band | MU-MIMO



Archer A8



1300 Mbps 5 GHz +
600 Mbps 2.4 GHz†



3 Antennas for
Superior Coverage†



Parental
Controls



EasyMesh-Compatible
for Seamless Wi-Fi^Δ



Full Gigabit
Ports



WPA3 Security*

Highlights

Speeds up to 1900 Mbps

1300 Mbps on the 5 GHz band and 600 Mbps on the 2.4 GHz are ideal for both everyday tasks and lag-free online entertainment. †

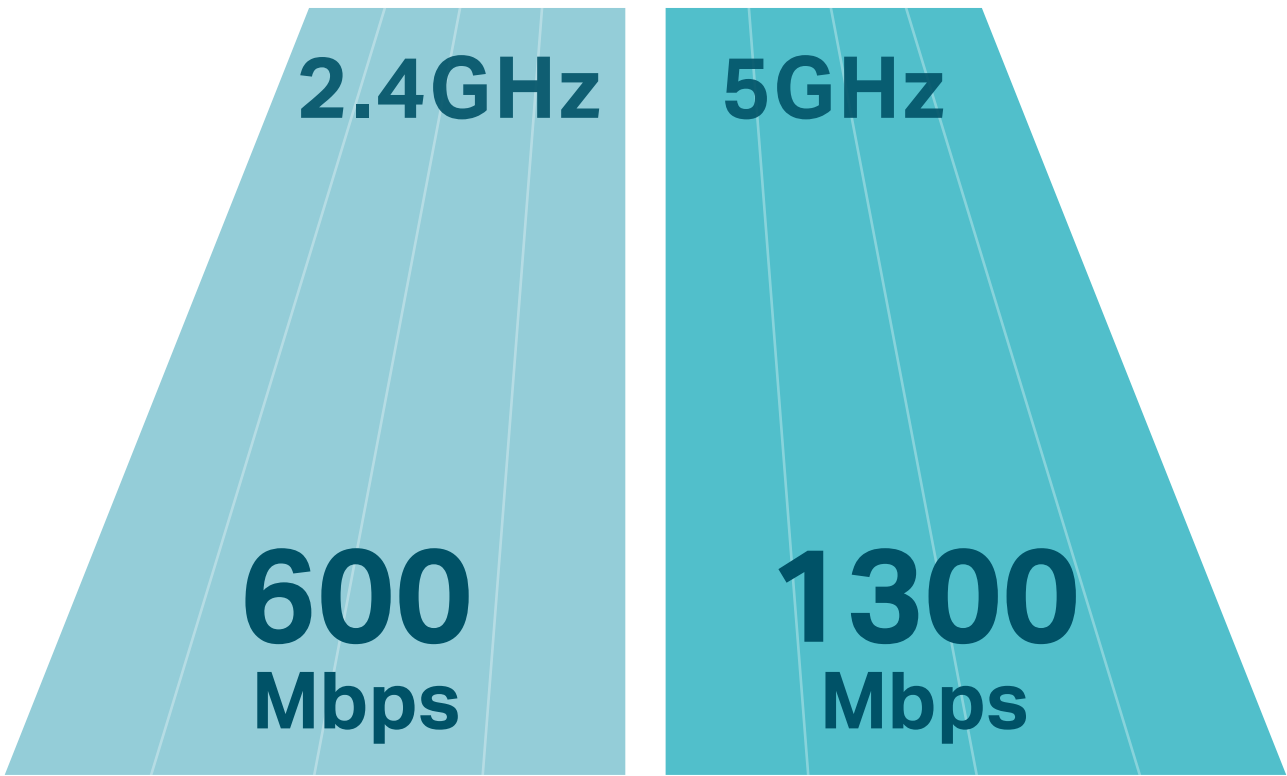

Smart Connect

Smart Connect unites 2.4 GHz and 5 GHz band into a single Wi-Fi SSID and helps the router automatically switch each device's connection to the best available Wi-Fi band.

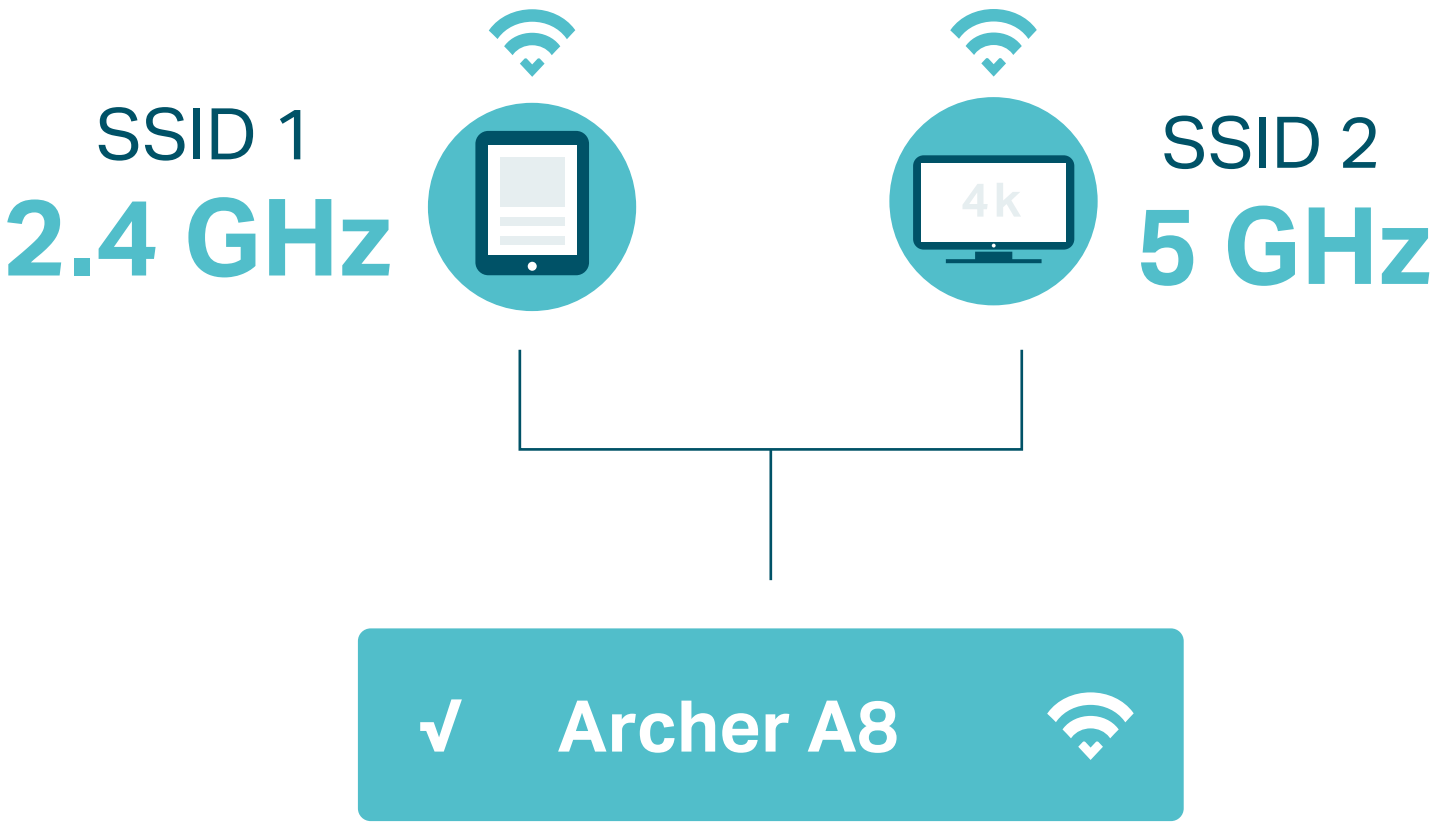

Highlights

Airtime Fairness

Equally divides network time between new devices, such as your gaming rig and older devices to improve your overall Wi-Fi performance and reliability.

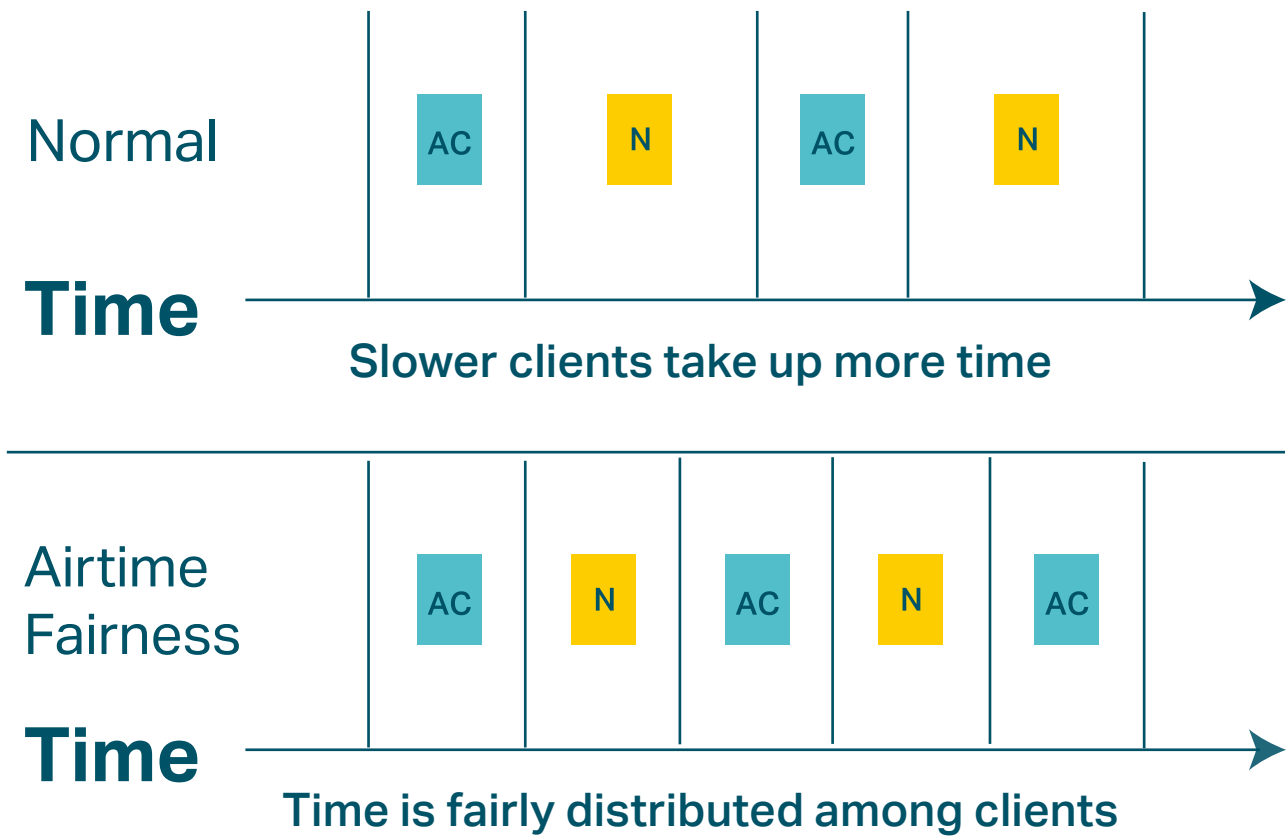

MU-MIMO

MU-MIMO technology serves multiple devices at once, reducing wait time, increasing Wi-Fi throughput for every device, and making each stream more efficient.[‡]

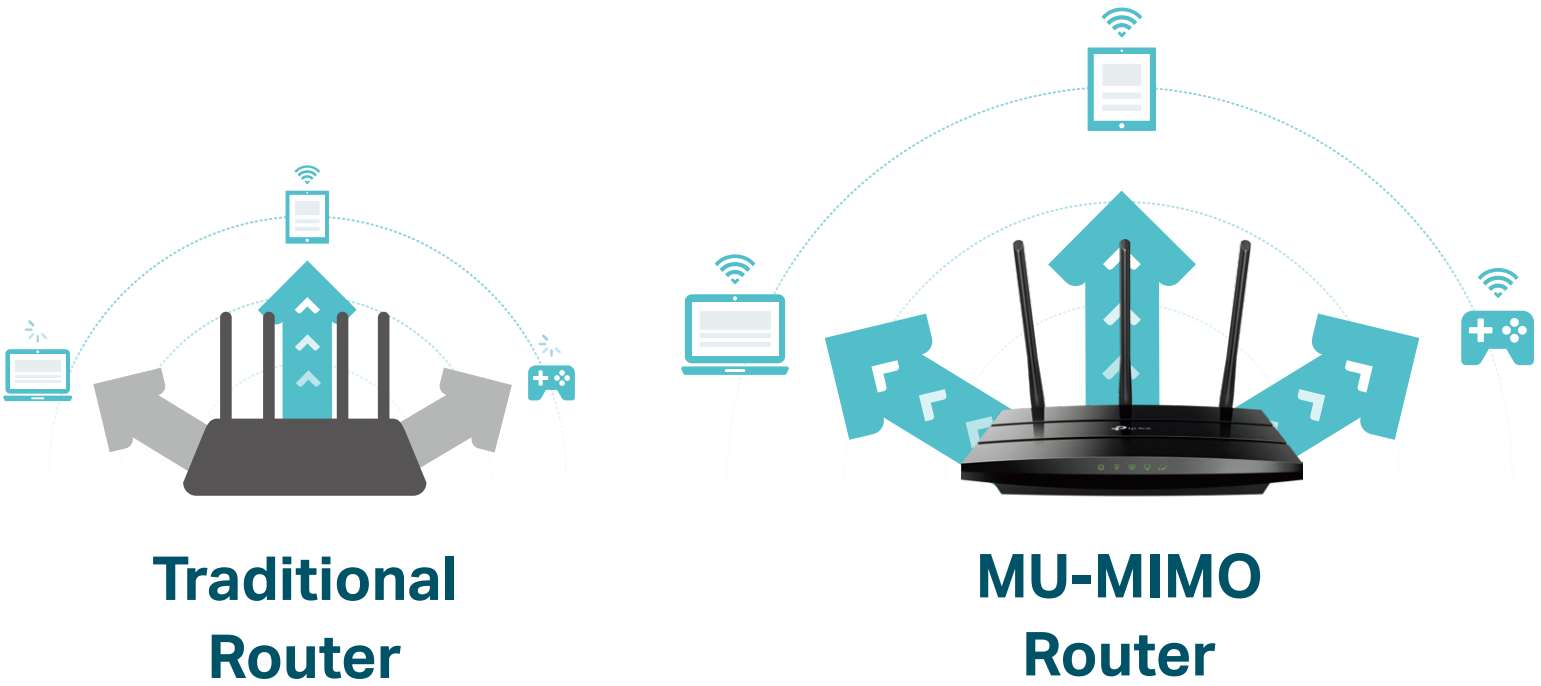

Highlights

Convenient Mesh Networking^Δ

Mesh networking creates smooth, fast, stable roaming. Archer A8 can build an EasyMesh network with devices that use EasyMesh technology. It eliminates Wi-Fi dead zones, expands your network, and fills your entire home with high-speed Wi-Fi.

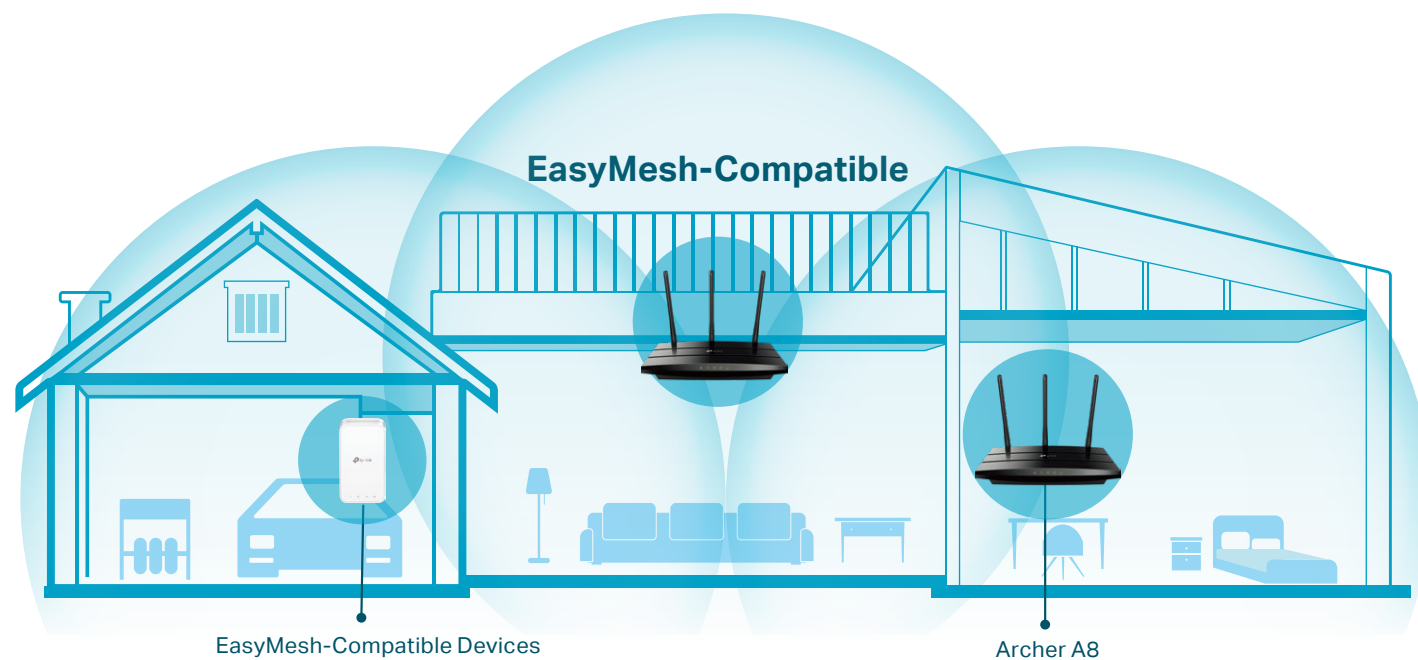

Easy Setup and Use

Installation is simple, thanks to an intuitive web interface and the powerful TP-Link app, Tether. Tether lets you manage your network settings with your smartphone.



Scan the QR code to download TP-Link Tether.

Features



Speed

- 802.11ac Technology – Powered by 802.11ac Wi-Fi technology, Archer A8 creates a reliable, blazing-fast network.
- Ultimate Wireless Speed – 1300 Mbps on 5 GHz + 600 Mbps on 2.4 GHz
- Gigabit Internet Access – Take full advantages of broadband speeds up to 1 Gbps

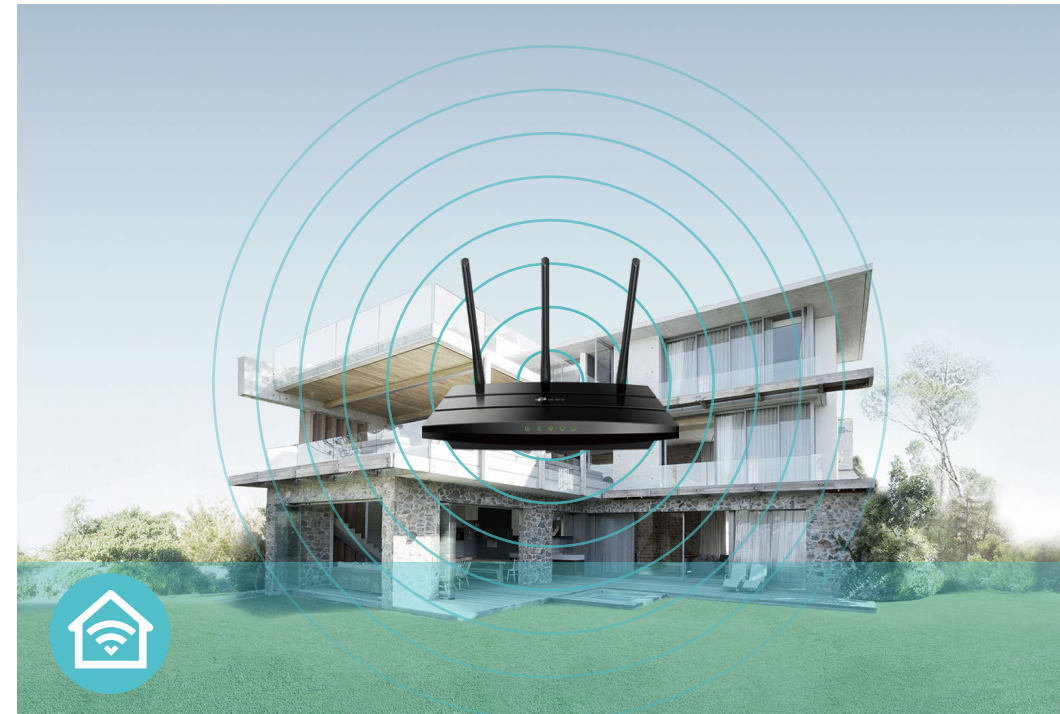

Wi-Fi Range

- Ultimate Range Wi-Fi – Three external antennas deliver a Wi-Fi signal to every corner of your home, making all of your connections more efficient and stable
- Beamforming Technology – Concentrates Wi-Fi signals towards individual devices to ensure stronger connections
- Seamless EasyMesh Network – Transfer between seamless whole-home Wi-Fi without any drops or lag and manage your whole network using a centralized panel



Reliability

- Airtime Fairness – Balances airtime usage of connected devices to improve overall throughput and efficiency
- Smart Connect – Intelligently switches each device's connection to the optimum available Wi-Fi band
- IoT Network – Creates a dedicated wireless network to manage IoT devices together and improve their connectivity stability

Features



Easy Management

- Intuitive Web UI – Ensures quick and simple Installation without hassle
- Hassle-free Management with Tether App – Network management is made easy with the TP-Link Tether App, available on any Android and iOS device
- TP-Link ID – Binds the router to your TP-Link ID and other family member's accounts to manage the router



Security

- Encryptions for Secure Network – WPA, WPA2, and WPA3 encryptions provide active protection against security threats
- Guest Network – Keeps your main network secure by creating a separate network for friends and visitors
- Parental Controls – Restricts internet access time and contents for children devices



Ease of Use

- Wi-Fi Sharing – Easily shares your Wi-Fi access with a QR code
- Wi-Fi Schedule –The wireless network can be automatically off within a specified period when you do not need the wireless connection
- LED Control – Automatically turns your router's LEDs off within a specified period

Specifications

Hardware

- Ethernet Ports: 1× 10/100/1000 Mbps WAN Port, 4×10/100/1000 Mbps LAN Ports
- Buttons: WPS/Wi-Fi Button, Power On/Off Button, Reset Button
- Antennas: 3 Fixed Omni Directional Antennas
- External Power Supply: US version 12V/1.5A
EU version 12V/1A
- Dimensions (W x D x H): 9.6 × 6.4 × 1.3 in (243 × 160.6 × 32.5mm)

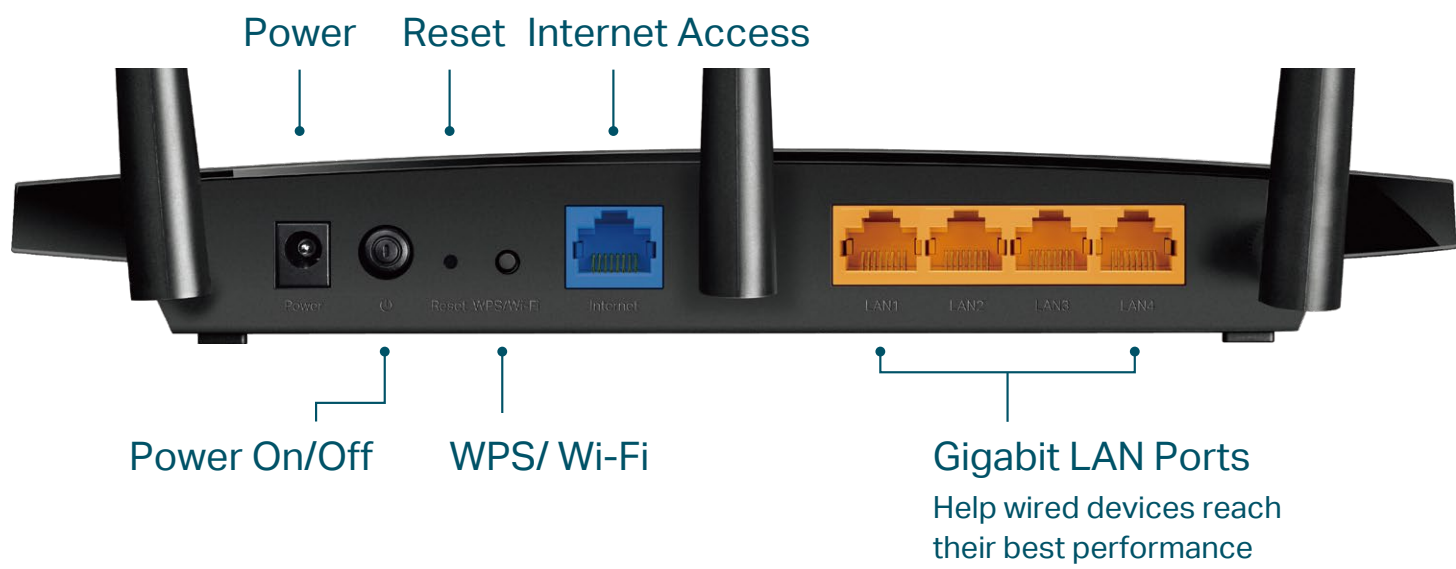

Wireless

- Standards: IEEE 802.11 ac/n/a 5 GHz, IEEE 802.11 n/b/g 2.4 GHz
- Wireless: 1300 Mbps on 5 GHz + 600 Mbps on 2.4 GHz
- Frequency: 2.4 GHz and 5 GHz
- Transmit Power:
CE: <20dBm(2.4 GHz), <23dBm(5.15 GHz~5.25 GHz)
FCC:<30dBm(2.4 GHz & 5 GHz)
- Reception Sensitivity:
5 GHz:
11a 6Mbps:-98dBm, 11a 54Mbps:-78dBm
11ac VHT20_MCS0:-98dBm, 11ac VHT20_MCS8:-72dBm
11ac VHT40_MCS0:-92dBm, 11ac VHT40_MCS9:-68dBm
11ac VHT80_MCS0:-89dBm, 11ac VHT80_MCS9:-64dBm
2.4 GHz:
11g 6Mbps:-97dBm, 11a 54Mbps:-77dBm
11n VHT20_MCS0:-97dBm, 11n VHT20_MCS8:-72dBm
11n VHT40_MCS0:-92dBm, 11n VHT40_MCS9:-67dBm
- Wireless Function: Enable/Disable Wireless Radio, WMM
- Wireless Security: WPA, WPA2, WPA3 encryptions

Specifications

Software

- Quality of Service: Device Prioritization
- WAN Type: Dynamic IP/Static IP/PPPoE(Dual Access)/PPTP(Dual Access)/L2TP(Dual Access)
- EasyMesh: Supported
- Management: Local Management, Remote Management
- DHCP: Server, DHCP Client List, Address Reservation
- NAT Forwarding: Port Forwarding, Port Triggering, UPnP, DMZ
- Dynamic DNS: DynDns, NO-IP, TP-Link
- Access Control: Allow List, Deny List
- Parental Controls: URL Filtering, Time Controls
- Firewall Security: SPI Firewall, IP and MAC Address Binding
- Protocols: IPv4, IPv6
- Guest Network: 2.4 GHz Guest Network, 5 GHz Guest Network

Others

- Certification:
CE, FCC, RoHS
- System Requirements:
Edge, Firefox, Chrome, Safari, or other JavaScript-enabled browser

*You are recommended to use the latest version

Cable or DSL Modem (if needed)

Subscription with an internet service provider (for internet access)
- Environment:
Operating Temperature: 0°C~40°C (32°F ~104°F)

Operating Humidity: 10%~90% non-condensing

Storage Humidity: 5%~90% non-condensing
- Package Contents

Wireless Router Archer A8

Power Adapter

RJ45 Ethernet Cable

Quick Installation Guide



For more information, please visit
https://www.tp-link.com/products/details/?model=Archer+A8_V2
or scan the QR code left

*Maximum wireless signal rates are the physical rates derived from IEEE Standard 802.11 specifications. Actual wireless data throughput and wireless coverage are not guaranteed and will vary as a result of network conditions, client limitations, and environmental factors, including building materials, obstacles, volume and density of traffic, and client location.
*Use of MU-MIMO requires clients to also support MU-MIMO.
*Use of WPA3 requires clients to also support WPA3.
*TP-Link EasyMesh-compatible products can network with other devices that use EasyMesh. Failed connections may be due to firmware conflicts of different vendors.The EasyMesh-Compatible function is still being developed on some models and will be supported in subsequent software updates.
*Actual network speed may be limited by the rate of the product's Ethernet WAN or LAN port, the rate supported by the network cable, Internet service provider factors and other environmental conditions.
©2024 TP-Link